

INTAKE MANIFOLD

COMPONENTS

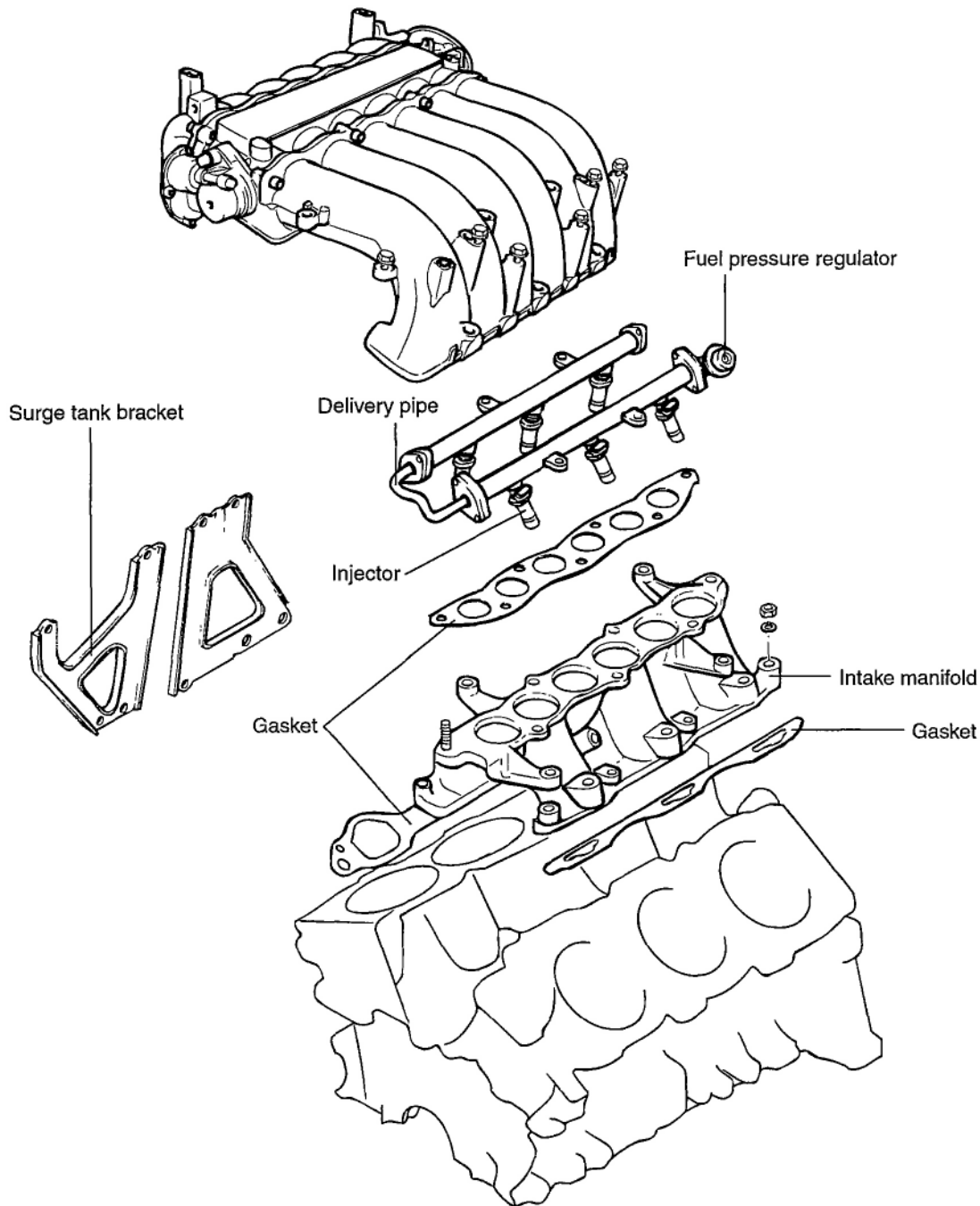

G00721148

Fig. 148: Identifying Intake Manifold Components
Courtesy of HYUNDAI MOTOR CO.

REMOVAL

1. Remove the air intake hose connected to the throttle body.

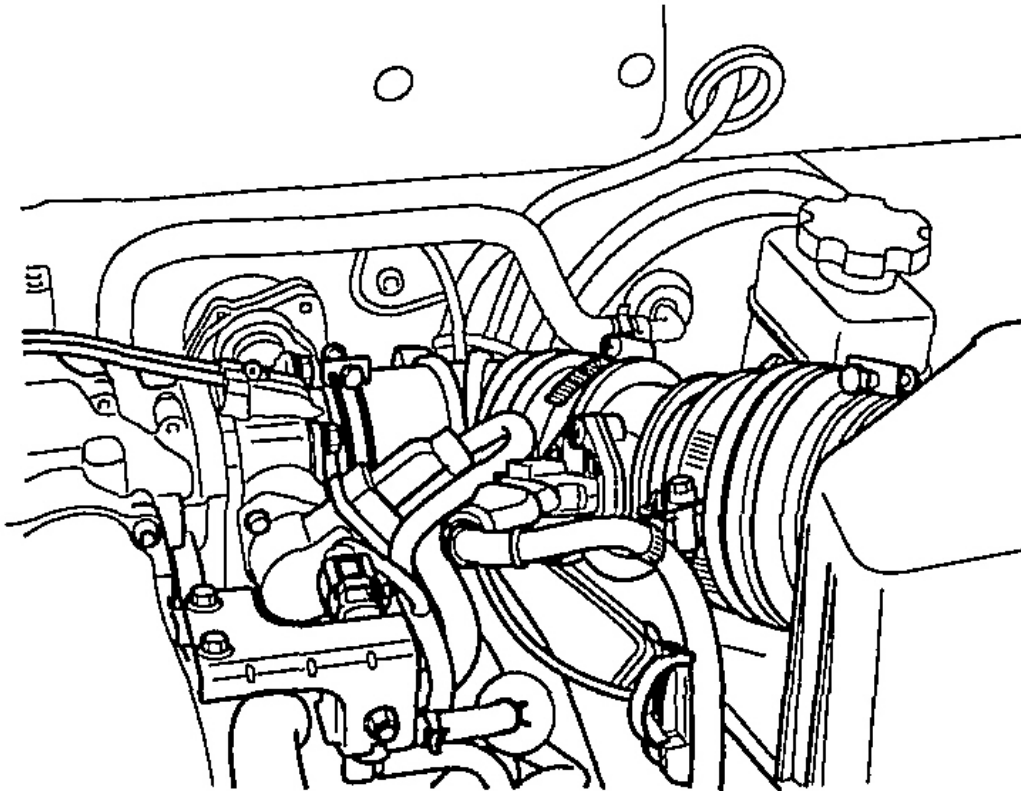

G00721149

Fig. 149: Removing Throttle Body Air Intake Hose
Courtesy of HYUNDAI MOTOR CO.

2. Remove the engine coolant hose and throttle body.
3. Remove the P.C.V. hose and brake booster vacuum hoses.

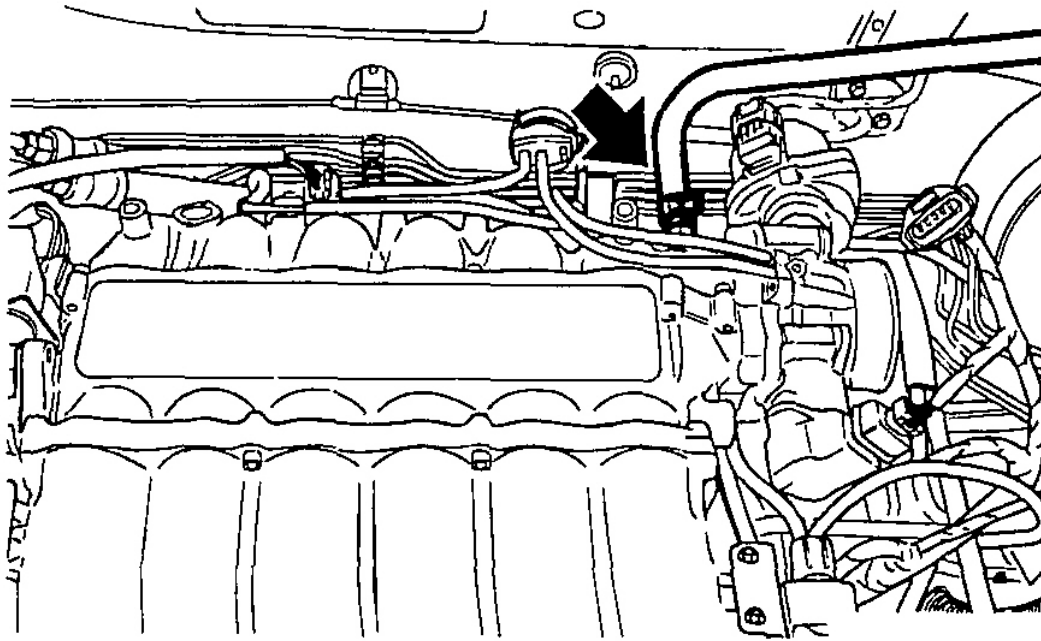

G00721150

Fig. 150: Removing PCV & Brake Booster Vacuum Hoses
Courtesy of HYUNDAI MOTOR CO.

4. Disconnect the vacuum hose connections.
5. Remove the surge tank stay.

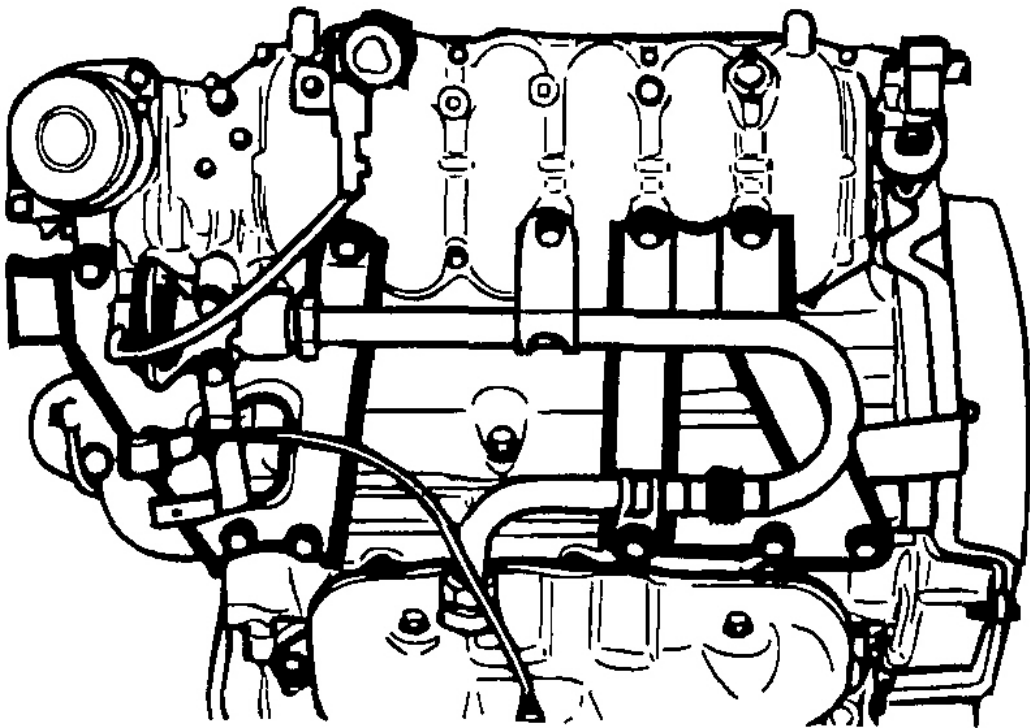

G00721151

Fig. 151: Removing Surge Tank Stay
Courtesy of HYUNDAI MOTOR CO.

6. Remove the surge tank.
7. Remove the surge tank and gasket.

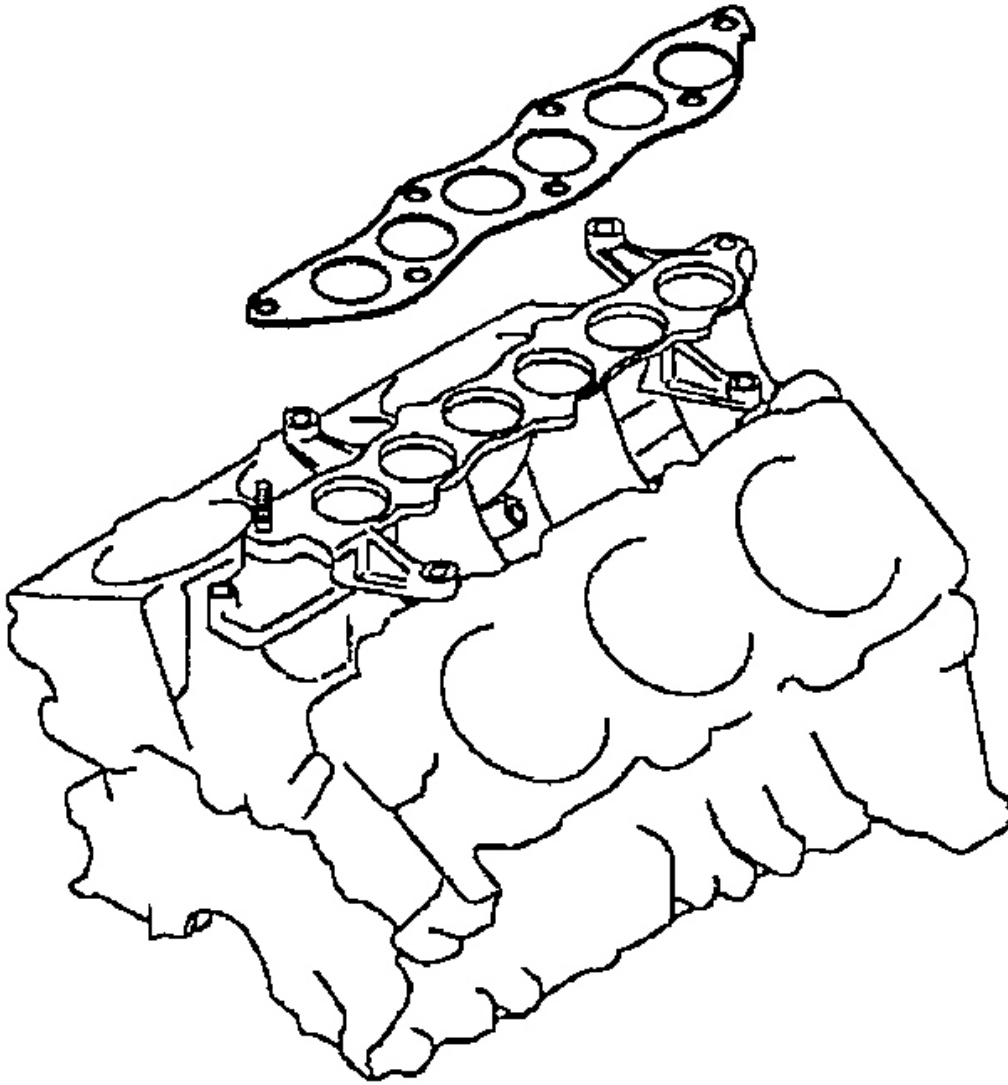

G00721152

Fig. 152: Removing Surge Tank Gasket
Courtesy of HYUNDAI MOTOR CO.