

[Select Vehicle](#) | [New TSBs](#) | [Technician's Reference](#)

 Component Search:
 [Conversion Calculator](#)

2005 Chrysler Pacifica V6-3.8L VIN L

[Vehicle Level](#) → [Locations](#) → [Connector Locations](#) → [Connector Location Index](#) ←

Connector Location Index

[Notes](#)

PLEASE NOTE:

If a link on the index chart to a figure is not provided, that means that the connector and/or figure in question does NOT apply to the vehicle model selected.

The abbreviation **T/O** (Take Out) is used in the location column to indicate a point in which the wiring harness branches out to a component.

The abbreviation **N/S** means Not Shown in the illustrations.

A/C - Auto

CONNECTOR NAME/NUMBER	COLOR	LOCATION	FIG.
A/C-Heater Control C1 (MTC)		Center Instrument Panel	18 23
A/C-Heater Control C2 (MTC)		Center Instrument Panel	18 23
A/C Compressor Clutch	LT GY	Right Front of Engine Compartment	10 11
A/C Pressure Transducer	GY	Right of Engine Compartment	8
Adjustable Pedals Motor	WT	Left Side of Body by Dash	28
Adjustable Pedals Sensor	BK	Left Side of Body by Dash	28
Airbag Control Module C1 (ORC)	YL	Center of Body by Console	29
Airbag Control Module C2 (ORC)	YL	Center Body by Console	16 24
Airbag Squib - Driver 1	YL/BK	Steering Wheel	25
Airbag Squib - Driver 2	YL/TN	Steering Wheel	25
Airbag Squib - Driver Knee Blocker	YL	Left Side of Dash	18 19 26
Airbag Squib - Left Curtain	YL	Left Upper B-Pillar	60
Airbag Squib - Passenger	YL	Right Side of Dash	18 19
Airbag Squib - Right Curtain	YL	Right Upper B-Pillar	62
Ambient Temperature Sensor	BK	Left Front of Engine Compartment	6
Amplifier C1	WT	Right Rear Body	34 36 38
Amplifier C2	WT	Right Rear Body	34 36 38
Antenna - Navigation		Right Front Body	18 19 26
Antenna - Radio		Center of Dash	18 20
Antenna - Radio Inline to Antenna-Side Glass		Right Instrument Panel	18 19
Antenna - Satellite Radio		Right Rear Body	68
Antenna - Side Glass		Right Side of Body	57
Auto Temp Control C1 (ATC)	BK	Center of Dash	18 23
Auto Temp Control C2 (ATC)	NAT	Center of Dash	18 23
Automatic Day/Night Mirror	BK	On the Windshield	25

Batt - Ciga

CONNECTOR NAME/NUMBER	COLOR	LOCATION	FIG.
Battery B(-)		Left Side of Engine Compartment	3, 4, 9
Battery B(+)		Left Side of Engine Compartment	3, 4, 9
Battery Temperature Sensor	BK	Left Side of Engine Compartment	3, 4, 9, 9
Blend Door Actuator - Driver	GY	On HVAC Assembly	17
Blend Door Actuator - Passenger	GY	On HVAC Assembly	17
Blower Motor Resistor Block (MTC)		Right Side Instrument Panel	13, 13
Body Control Module - C1	BK	Left Side of Dash	22, 28
Body Control Module - C2	BK/GN	Left Side of Dash	22, 28
Body Control Module - C3	BK/NAT	Left Side of Dash	22, 28
Body Control Module - C4	BK/GY	Left Side of Dash	18, 22, 24
Body Control Module - C5	BK/BK	Left Side of Dash	18, 22, 24
Brake Fluid Level Switch	BK	Left Rear Engine Compartment	3, 9
Brake Lamp Switch	BK	Left Side of Body by Dash	28
C100	BK	Left Front of Engine Compartment	5, 5
C101	BK	Left Front of Engine Compartment	4, 5
C102	BK	Left Front of Engine Compartment	4, 5
C104 (3.5 L)	LT GY	Left Rear Engine Compartment	3, 13, 13
C105	LT GY	Left Front of Engine Compartment	3, 4, 5, 5
C106		Right Top Engine	11
C107		Right Top Engine	11
C200	LT GY	Front Console	18, 26
C201	GY/BK	Left Side of Dash	18, 22, 22, 23
C202	DK GY	Right Side of Dash	17, 18, 18
C204 (DVD)	BK	Right Side of Dash	18, 22, 33
C205	NAT/ WT	Right Side of Dash	18, 18, 22, 33
C300	LT GY	Rear Console	28, 27, 28, 33
C301	BK	Left Side A-Pillar	28, 31
C303	BK	Left Side B-Pillar	31, 32
C304	BK	Right Side A-Pillar	33, 31
C306	BK	Right Side B-Pillar	33, 32
C307	BK	Center Rear of Body	32, 47
C308 (Power Liftgate)	BK	Center Rear of Body	32, 47
C312 (Except Base)	BK	Left Side Body by A-Pillar	28, 16
C313	LT GY	Left Side Body by A-Pillar	28, 16
C315 (Satellite Radio)	WT	Right Side of Dash	18, 22, 33
C316 (Lumbar Seat Adjuster)	WT	Left Side of Driver Seat	36
C317		Body Near Upper Left Liftgate	39
C318		Left Rear Underbody	45
Camshaft Position Sensor	BK	Right Engine	18, 18
Center High Mounted Stop Lamp	BK	Top of Liftgate	37
Cigar Lighter	GY	Center of Dash	18, 24, 24

Zoom

Sized for Print

Circ - Fron

CONNECTOR NAME/NUMBER	COLOR	LOCATION	FIG.
Circuit Breaker - Power Seat	GY	Left Side of Dash	22, 23
Clockspring C1	WT	Steering Column	18, 24
Clockspring C2	YL	Steering Column	18, 24
Clockspring C3	BK	Steering Wheel	25
Clockspring C4	BK	Steering Wheel	25
Coil On Plug No. 1	LT GY	Rear Engine	13
Coil On Plug No. 2	LT GY	Front Engine	N/S
Coil On Plug No. 3	LT GY	Rear Engine	13
Coil On Plug No. 4	LT GY	Front Engine	N/S
Coil On Plug No. 5	LT GY	Rear Engine	13
Coil On Plug No. 6	LT GY	Front Engine	N/S
Controller Antilock Brake	BK	Left Front Engine Compartment	3, 8, 10, 11
Courtesy Lamp - Driver	GY	In Door	40
Courtesy Lamp - Passenger	GY	In Door	40
Crankshaft Position Sensor	BK	Left Side of Engine	3, 8, 10, 11
Data Link Connector	BK	Left Instrument Panel	18, 19, 22
Dome Lamp (Base)		Center Headliner	18
Door Lock Motor/Ajar Switch - Driver	BK	In Door	31
Door Lock Motor/Ajar Switch - Driver Rear	BK	In Door	32
Door Lock Motor/Ajar Switch - Passenger	BK	In Door	31
Door Lock Motor/Ajar Switch - Passenger Rear	BK	In Door	32
Door Module - Driver C1	GY	In Door	31
Door Module - Driver C2	BK	In Door	31
Door Module - Driver C3	BK	In Door	40
Door Module - Passenger C1	GY	In Door	40
Door Module - Passenger C2	BK	In Door	31
Door Module - Passenger C3	BK	In Door	31
DVD Screen	BK	Upper Console Headliner	18
DVD/CD Changer C1	BK	Center of Dash	18, 20
DVD/CD Changer C2	BK	Center of Dash	18, 20
EGR Solenoid	BK	Left of Engine	15
Engine Coolant Temperature Sensor	BK	Left of Engine	15
Engine Oil Pressure Switch	BK	Lower Center Engine	10, 13
EVAP/Purge Solenoid	BK	Top Right Side of Engine	10, 13
Evaporator Temperature Sensor	BK	On the HVAC Assembly	17
Fog Lamp - Left	BK	At Lamp in Front Bumper	9
Fog Lamp - Right	BK	At Lamp in Front Bumper	1, 8
Front Blower Power Module C1	BK	On HVAC Assembly	17

Zoom

Sized for Print

Fron - Inte

CONNECTOR NAME/NUMBER	COLOR	LOCATION	FIG.
Front Blower Power Module C2	BK	On HVAC Assembly	7
Fuel Injector No. 1	BK	Rear Engine	13
Fuel Injector No. 2	BK	Top Front of Engine	12
Fuel Injector No. 3	BK	Rear Engine	13
Fuel Injector No. 4	BK	Top Front of Engine	N/S
Fuel Injector No. 5	BK	Rear Engine	13
Fuel Injector No. 6	BK	Top Front of Engine	N/S
Fuel Pump Module	BK	Behind Fuel Tank	66 69
Generator	BK	On Engine	10 11
Glove Box Lamp	BL	Right Side of Dash	13 15 20
Hands Free Module	GY	Low Center Body	66
Headlamp - Left	BK	At Left Headlamp Opening	5 7
Headlamp - Right	BK	At Right Headlamp Opening	11 8
Heated Seat Back - Driver	GN	Left Side of Seat	44
Heated Seat Cushion - Driver	DK GY	Inside Seat	44
Heated Seat Switch - Left Middle Row	BK	Rear Center Console	27
Heated Seat Switch - Right Middle Row	GN	Rear Center Console	27
Heated Seat - Left Middle Row	DK GY	Left Side of Body	40 45
Heated Seat - Right Middle Row	DK GY	Right Side of Body	34 45
Horn - High Note	BK	Right Front Frame Rail	2 8
Horn - Low Note	BK	Right Front Frame Rail	2 8
Idle Air Control Motor	BK	Right Rear Engine	13 13
Ignition Coil (3.8 L)		Left Rear Engine	13
Ignition Switch	BK	Left Side of Dash	13 19 26
Impact Sensor - Left Front	BK	Left Front of Engine Compartment	5
Impact Sensor - Left Side 1	BK	Left Side B-Pillar	30
Impact Sensor - Left Side 2	BK	Left Side of Body	30
Impact Sensor - Right Front	BK	Right Front of Engine Compartment	5
Impact Sensor - Right Side 1	DK GY	Right Side B-Pillar	63
Impact Sensor - Right Side 2	DK GY	Right Side of Body	62
Instrument Cluster C1	BK	Left Side of Dash	18 24
Instrument Cluster C2 (Navigation)	BK	Left Side of Dash	18 24
Instrument Panel Switch POD	BK	Center of Dash	13 24
Intake Air Temperature Sensor	BK	Top Right of Engine	9 13 15
Integrated Power Module Battery Feed	-	Left Front Engine Compartment	3 4
Integrated Power Module C1	BK	Left Front Engine Compartment	3 4
Integrated Power Module C2	DK GY	Left Front Engine Compartment	3 4
Integrated Power Module C3	GY	Left Front Engine Compartment	5
Integrated Power Module C4	GN	Left Front Engine Compartment	3 5

Zoom

Sized for Print

Inte - Park

CONNECTOR NAME/NUMBER	COLOR	LOCATION	FIG.
Integrated Power Module C5	GY	Left Front Engine Compartment	3
Integrated Power Module C6	GY	Left Front Engine Compartment	3, 4
Integrated Power Module C7	GY	Left Front Engine Compartment	3, 4
Integrated Power Module C8	WT	Left Front Engine Compartment	3, 4
Integrated Power Module C9	BL	Left Front Engine Compartment	3, 4
Knock Sensor	BK	Left of Engine	3, 4, 12
License Lamp	RD	Rear Liftgate	47, 21
Liftgate Cinch/Release Motor (Power Liftgate)	BL	Rear Liftgate	47
Liftgate Flood Lamp	GY	Rear Liftgate	47
Liftgate Handle Switch	BK	Rear Liftgate	47
Liftgate Lock Motor/Ajar Switch (Base)	BK	Rear Liftgate	47
Liftgate Pinch Sensor - Left (Power Liftgate)	BK	Rear Liftgate	47
Liftgate Pinch Sensor - Right (Power Liftgate)	BK	Rear Liftgate	47
Manifold Absolute Pressure Sensor	GY	Left Top of Engine	12, 15
Manifold Tuning Valve Solenoid	DK GY	Top Right Front of Engine	12
Memory/Heated Seat Adjustable Pedals Module C1	DK GY	Center Console	25, 26, 28
Memory/Heated Seat Adjustable Pedals Module C2	GY	Under Driver Seat	43
Memory/Heated Seat Adjustable Pedals Module C3	WT	Under Driver Seat	43
Memory/Heated Seat Adjustable Pedals Module C4	GY	Center Console	25, 27, 28
Mode Door Actuator - Front	GY	On the HVAC Assembly	17
Mode Door Actuator - Rear	DK GY	In Rear Console	25
Multi-Function Switch	BK	Steering Column	18, 22
Natural Vacuum Leak Detection Assembly	BK	Left Side Body Under A-Pillar	3, 8, 35
Navigation Module	BK	Left Rear Body	33, 34
Noise Suppressor	-	Engine	12
Overhead Console	BK	Front Headliner	31
Oxygen Sensor - 1/1 Upstream	BK	Left Rear Engine	1, 14
Oxygen Sensor - 1/2 Downstream	WT	Rear of Engine	3, 8, 10, 11
Park Brake Switch	-	Left Front Corner of Dash	23
Park Display Module		Body Near Top Center Liftgate	32
Park Module		Left Rear Body	33
Park Sensor No.7		Rear Fascia	N/S
Park Sensor No.8		Rear Fascia	N/S
Park Sensor No.9		Rear Fascia	N/S

Zoom

Sized for Print

Park - Radi

CONNECTOR NAME/NUMBER	COLOR	LOCATION	FIG.
Park Sensor No.10		Rear Fascia	N/S
Passenger Seat		Passenger Seat	23
Power Liftgate Drive Unit	DK GY	Left Rear Body	31
Power Liftgate Module C1	BK	Left Rear Body	31
Power Liftgate Module C2	BK	Left Rear Body	31
Power Mirror - Driver	BK	Corner of Door	40
Power Mirror - Passenger	BK	Corner of Door	40
Power Outlet - Front Console	GY	Center Console	25
Power Outlet - Instrument Panel	GY	Center of Dash	1, 24, 25
Power Outlet - Rear	GY	Left Rear Body	32
Power Seat Motor - Driver Front Riser	BK	In Driver Seat	43
Power Seat Motor - Driver Horizontal	BK	Under Driver Seat	43
Power Seat Motor - Driver Lumbar	BK	In Driver Seat	42
Power Seat Motor - Driver Rear Riser	BK	In Driver Seat	42
Power Seat Motor - Driver Recliner	DK GY	In Driver Seat	42
Power Seat Motor - Passenger Horizontal	BK	In Passenger Seat	N/S
Power Seat Motor - Passenger Recliner	DK/GY	In Passenger Seat	42
Power Seat Switch - Driver	BK	Driver Door	41
Power Seat Switch - Passenger	BK	Passenger Door	41
Power Sunroof Module	BK	Left Upper Body	30
Power Window Motor - Driver	LT GY	Middle of Driver Door	39
Power Window Motor - Driver Rear	LT GY	Middle of Driver Rear Door	39
Power Window Motor - Passenger	LT GY	Middle of Passenger Rear Door	40
Power Window Motor - Passenger Rear	LT GY	Middle of Passenger Rear Door	42
Power Window Switch - Driver Rear	BK	Middle of Driver Rear Door	42
Power Window Switch - Passenger Rear	BK	Middle of Passenger Rear Door	42
Powertrain Control Module C1	BK/BK	Left Front of Engine Compartment	7
Powertrain Control Module C2	BK/OR	Left Front of Engine Compartment	7
Powertrain Control Module C3	BK/WT	Left Front of Engine Compartment	7
Powertrain Control Module C4	BK/GN	Left Front of Engine Compartment	7
Radiator Fan Motor No. 1	BK	Center Engine Compartment	5
Radiator Fan Motor No. 2	BK	Center Engine Compartment	6
Radiator Fan Relay	BK	Left Front Engine Compartment	6

Zoom

Sized for Print

Radi - SKREEM

CONNECTOR NAME/NUMBER	COLOR	LOCATION	FIG.
Radio C1	DK GY	Center of Dash	18 20
Radio C2 (DVD/CD Changer)	DK GY	Center of Dash	18 20
Radio C2 (Satellite Radio)	DK GY	Center of Dash	19
Reading Lamp - Front	BK	Front Headliner	46
Reading/Courtesy Lamp - Left Middle	GY	Left Headliner	46
Reading/Courtesy Lamp - Left Rear	GY	Left Rear Headliner	46
Reading/Courtesy Lamp - Right Middle	GY	Right Headliner	46
Reading/Courtesy Lamp - Right Rear	GY	Right Rear Headliner	46
Reading Lamp-Rear (Base)		Center Rear Headliner	
Rear Booster Fan Power Module C1	BK	Middle Center of Body	26 29
Rear Booster Fan Power Module C2	BK	Middle Center of Bodyh	26 29
Rear Booster Fan Rear Control Switch	BK	Rear Center Console	27
Rear Window Defogger Feed		Right Side Liftgate	47
Rear Window Defogger Ground		Left Side Liftgate	47
Rear View Mirror	BK	On Windshield Glass	26
Recirculation Door Actuator	GY	On the HVAC Assembly	17
Remote Radio Switch - Left	BK	Steering Wheel	25
Remote Radio Switch - Right	BK	Steering Wheel	25
Satellite Radio Multiplexer C1	DK GY	Center of Dash	19
Satellite Radio Multiplexer C2	DK GY	Center of Dash	18 20
Satellite Radio Receiver	BK	Right Rear Body	28
Seat Belt Force Sensor		Right Side B-Pillar	28
Seat Belt Switch - Driver	DK GY	Left Side B-Pillar	30
Seat Belt Tensioner - Driver	YL	Left Side B-Pillar	30
Seat Belt Tensioner - Passenger	YL	Right Side B-Pillar	28
Seat Heater Interface Module	GN	Rear Center Console	27
Seat Position Sensor - Driver Front Riser	WT	In Driver Seat	43
Seat Position Sensor - Driver Horizontal	WT	In Driver Seat	43
Seat Position Sensor - Driver Rear Riser	WT	In Driver Seat	43
Seat Position Sensor - Driver Recliner	BK	In Driver Seat	22
Shift Lever Assembly		Below Center Console	18 21
Short Runner Valve Solenoid	GY	Left Rear Engine	18
SKREEM Module	BK	Center of Dash	18 19 20

Zoom

Sized for Print

Spea - Wipe

CONNECTOR NAME/NUMBER	COLOR	LOCATION	FIG.
Speaker - Center Instrument Panel	BK	Center of Dash	18, 24
Speaker - Left Front Door Tweeter	BK	Driver Door	40
Speaker - Left Front Door Woofer	WT	Driver Door	40
Speaker - Left Rear Door	WT	Left Rear Door	32
Speaker - Right Front Door Tweeter	BK	Passenger Door	40
Speaker - Right Front Door Woofer	WT	Passenger Door	40
Speaker - Right Rear Door	WT	Right Rear Door	32
Speaker - Subwoofer	RD	Right Rear Body	42, 48
Speed Control Servo	BK	Left Front Engine Compartment	6
Speed Control Switch - Left	BK	On the Steering Wheel	25
Speed Control Switch - Right	BK	On the Steering Wheel	25
Speed Sensor - Input	GY	Left Side of the Engine	3, 8, 10, 11
Speed Sensor - Output	GY	Left Side of the Engine	3, 10, 11
Starter Motor	-	Lower Center Engine	10, 11
Tail Lamp - Left	BK	Left Rear Body	33
Tail Lamp - Right	BK	Right Rear Body	42, 49
Throttle Position Sensor	GY	Right Rear Engine	10, 13
Traction Control Switch	BK	Under Front Console	18, 26
Trailer Tow Connector	BK	Left Rear Body	43
Transmission Range Sensor	DK GY	Left Front of Engine	3, 4, 10, 11
Transmission Solenoid/Pressure Switch Assembly	BK	Left Side of Engine	3, 4, 10, 11
Visor/Vanity Lamp - Left	BK	Left Front Headliner	45
Visor/Vanity Lamp - Right	BK	Right Front Headliner	46
Washer Fluid Level Switch	GY	Left Lower Front of Engine	7
Washer Pump Motor - Front	NAT	Left Lower Front of Engine	7
Wheel Speed Sensor - Left Front	LT GY	Left Rear of Engine Compartment	7
Wheel Speed Sensor - Left Rear	LT GY	Left Rear Side of Body	43
Wheel Speed Sensor - Right Front	LT GY	Right Rear of Engine Compartment	8
Wheel Speed Sensor - Right Rear	LT GY	Right Rear Side of Body	42
Wiper Module - Front	BK	Rear Center of Engine Compartment	3, 8, 11
Wiper Module - Rear	NAT	Liftgate	37
Wiper/Washer Switch	WT	Lower Steering Column	18, 24

Zoom

Sized for Print

814000e4

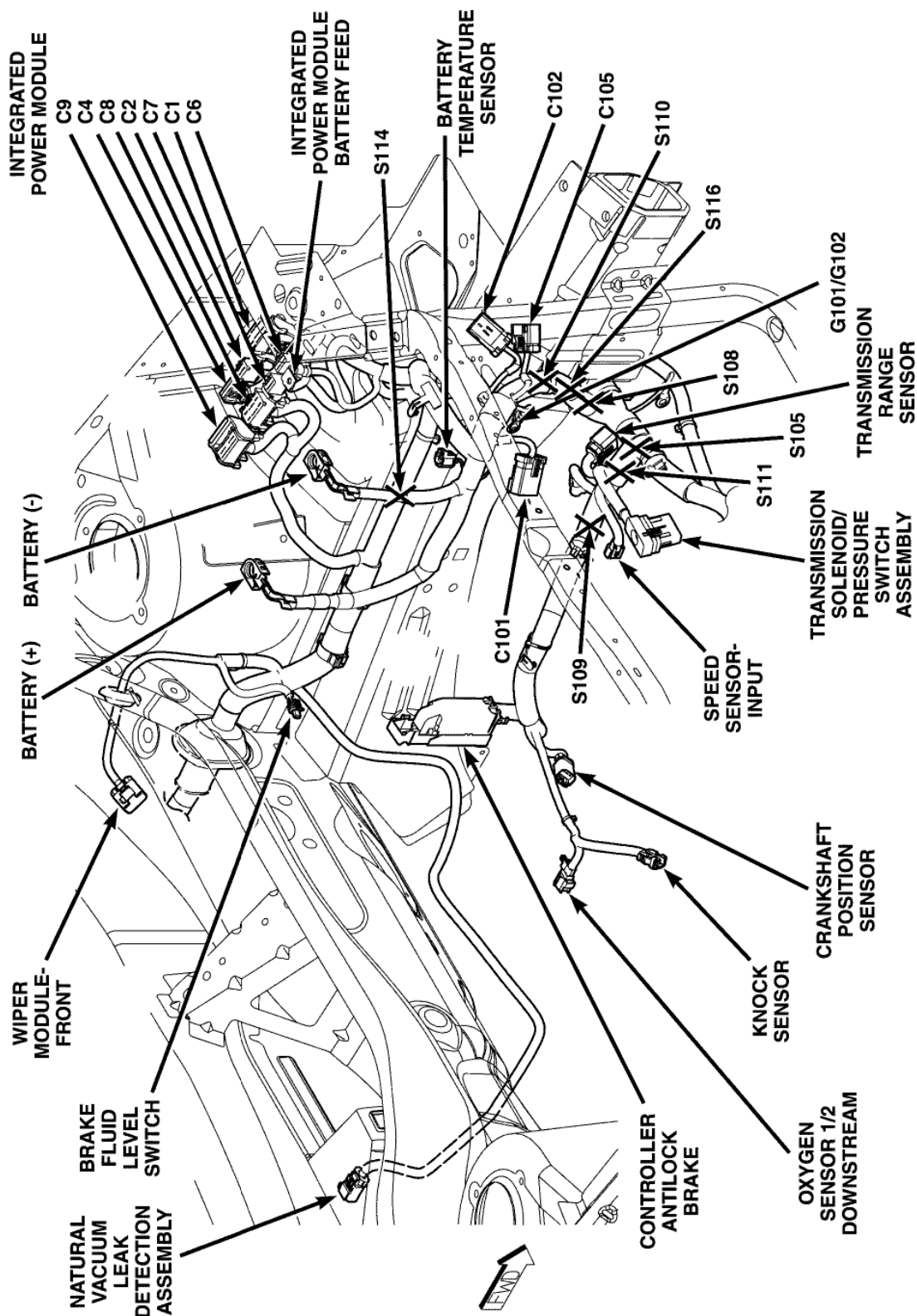

ENGINE COMPARTMENT - LEFT FRONT 3.8L

[Select Vehicle](#) | [New TSBs](#) | [Technician's Reference](#)Component Search:  [Conversion Calculator](#)**2005 Chrysler Pacifica V6-3.8L VIN L**[Vehicle Level](#) → [Body and Frame](#) → [Seats](#) → [Testing and Inspection](#) → [Diagnostic Strategies](#) ←**Diagnostic Strategies**[Notes](#)

The most reliable, efficient, and accurate means to diagnose the memory system requires the use of a DRB III(R) scan tool and the proper Diagnostic Procedures information. In order to obtain conclusive testing of the memory system, the Programmable Communications Interface (PCI) data bus network and all of the electronic modules that provide inputs to, or receive outputs from the memory system components must be checked. The DRB III(R) scan tool can provide confirmation that the PCI data bus is functional, that all of the electronic modules are sending and receiving the proper messages on the PCI data bus, and that the memory system is receiving the proper hard wired inputs and relaying the proper hard wired outputs to perform its functions. The scan tool is used to retrieve any diagnostic trouble codes (DTC's) that could be related to the memory system.

Following are tests that will help to diagnose the hard wired components and circuits of the memory system.

PRELIMINARY TESTS

1. If any power seat is not operational in any direction, check the power seat circuit breaker, located in the Integrated Power Module. If OK, go to Step 2. Refer to the Power Distribution for circuit breaker diagnosis and testing procedure.
2. Check for proper battery or electrical system voltage. The CS is equipped with a low-voltage cutoff feature. If the electrical system voltage drops below a predetermined set-point (**approx. 11.5v**), the power seat system will not function until the proper system voltage has been restored. If OK, go to Step 3. Refer to the Battery System and/or Charging System for testing instructions.
3. Obtain a DRB III(R) scan tool and check for any stored diagnostic trouble codes recorded in the memory heated seat adjustable pedal module. Follow the procedures called out in the proper diagnostic procedures to resolve if codes are present.
4. To check the memory heated seat adjustable pedal module for proper output, obtain a DRB III(R) scan tool, energize each [seat track](#) motor axis one at a time. If any axis stops without hitting the end of travel, the potentiometer signal for that axis may have an open, short or be mis-wired. Check the wiring to that axis (module to motor). Fix any wiring problems and retry that axis.

© 2008 ALldata LLC. All rights reserved.

[Terms of Use](#)

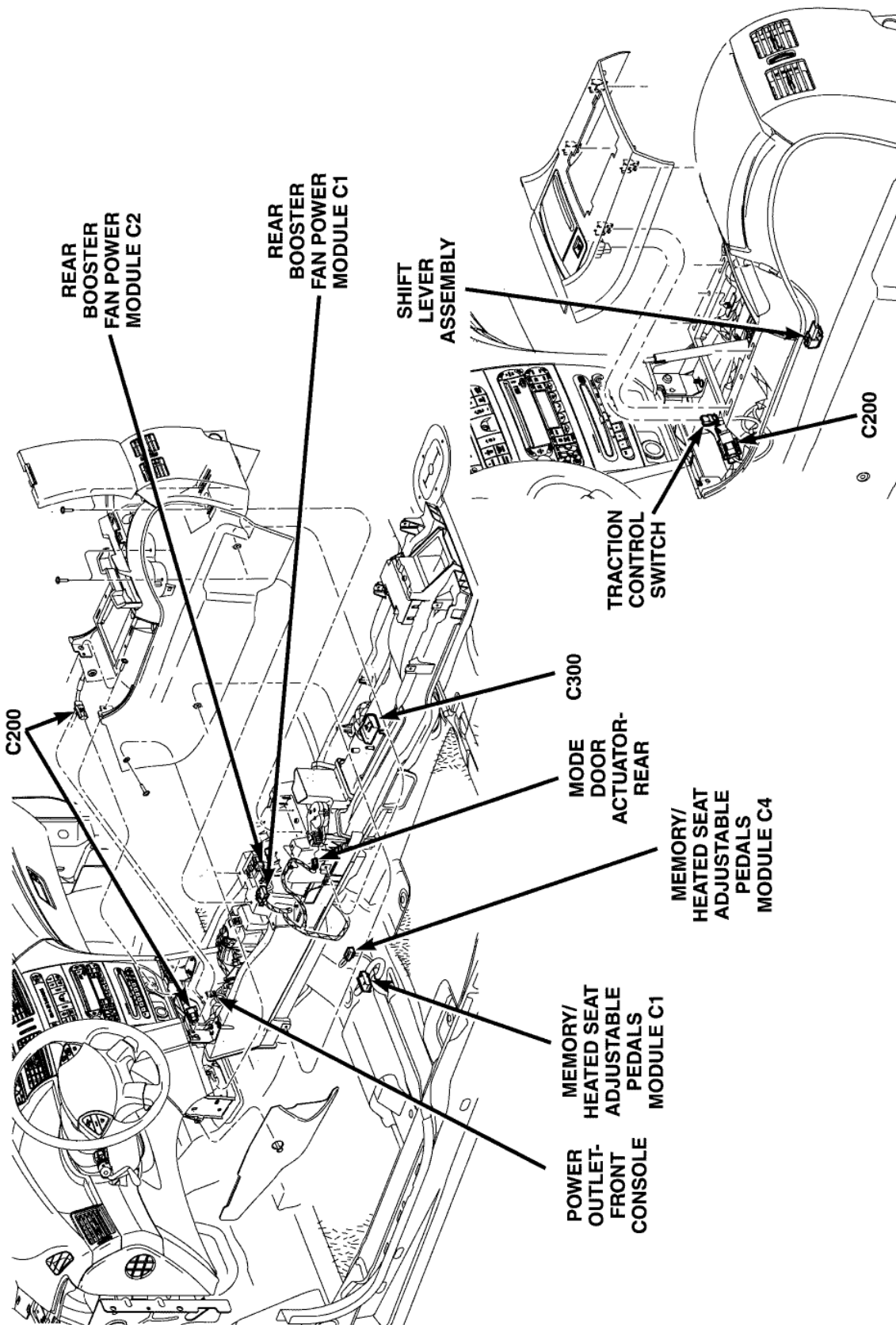

81401033

BODY - CENTER

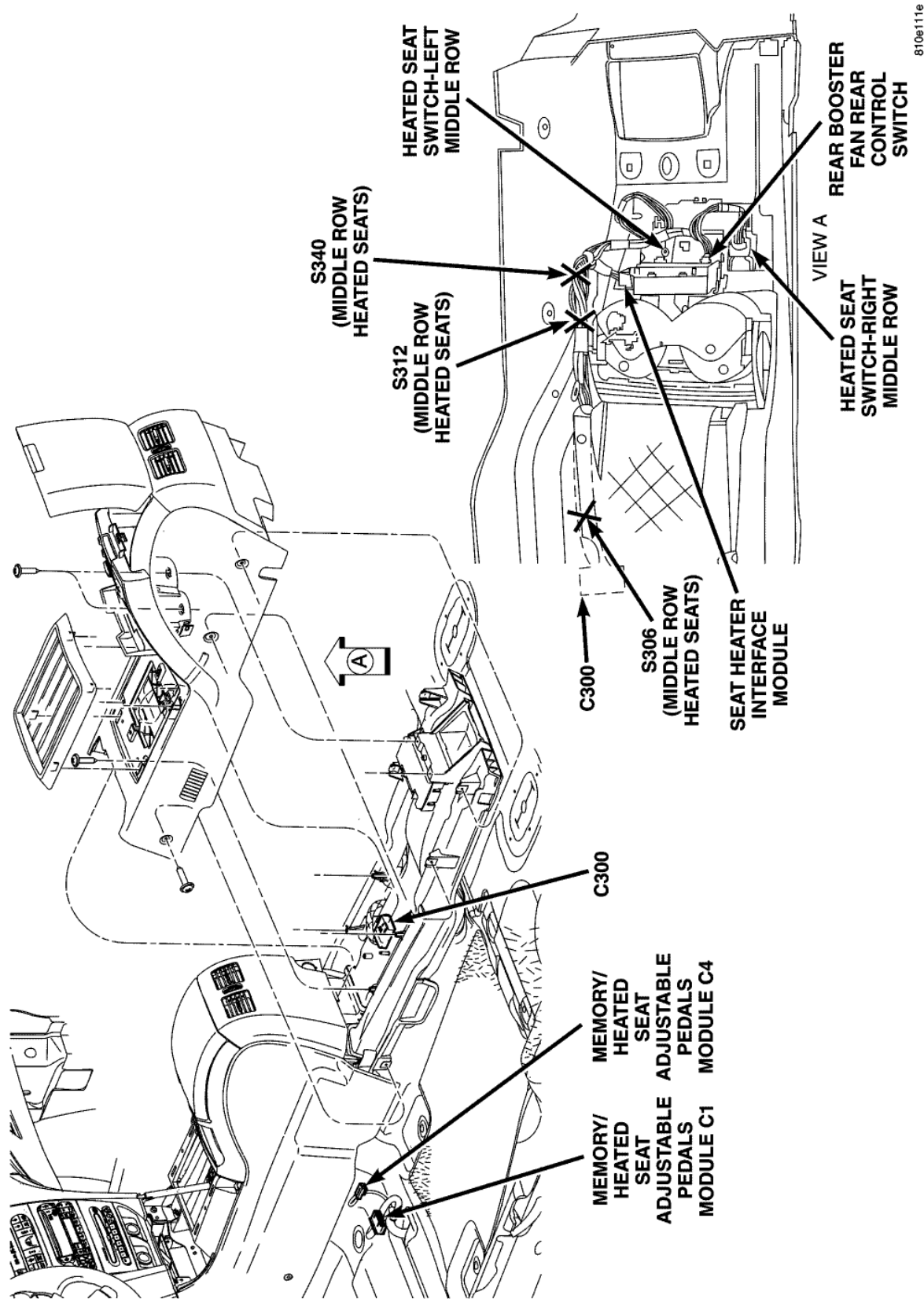

BODY - CENTER CONSOLE

810e111e

Select Vehicle | New TSBs | Technician's Reference

Component Search:

Conversion Calculator

2005 Chrysler Pacifica V6-3.8L VIN L

[Vehicle Level](#) → [Relays and Modules](#) → [Relays and Modules - Power and Ground Distribution](#) → [Relay Box](#) → [Locations](#) ←

Locations

[Notes](#)

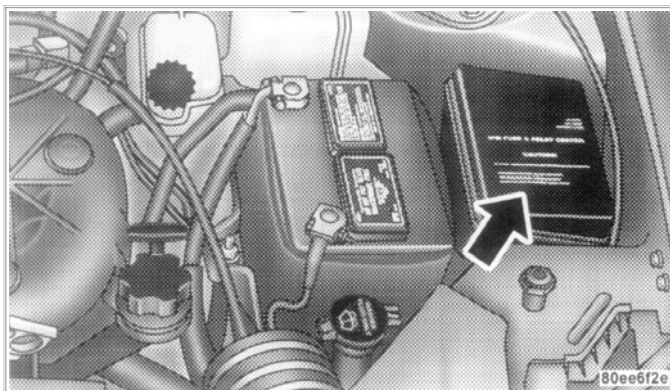
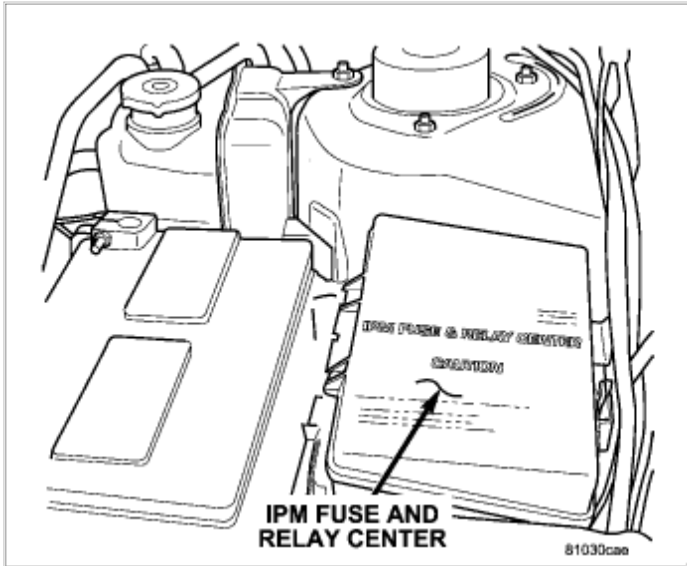

Cavity Maxi Fuse Description

- 1 40 Amp/Green Anti-Lock Brake System (ABS) Pump
- 2 Spare
- 3 30 Amp/Pink Ignition Off Draw (100)
- 4 40 Amp/Green Body Control Module (BCM) Feed 1
- 5 40 Amp/Green Electronic Back Light (EBL)
- 6 30 Amp/Pink Front Wipers
- 7 40 Amp/Green Starter
- 8 40 Amp/Green Power Seat C/B
- 9 40 Amp/Green Power Sunroof
- 10 Spare
- 11 40 Amp/Green Headlight Washer, Power Liftgate
- 12 Spare
- 13 40 Amp/Green Radiator Fan 1
- 14 Spare
- 15 40 Amp/Green Anti-Lock Brake System (ABS) Module
- 24 20 Amp/Yellow Power Outlet (Selectable)
- 25 15 Amp/Blue Radio, Amplifier, Navigation, Hands-Free Phone (HFM),
Electronic Vehicle Information Center (EVIC), EC, SNRF, Mirror
- 26 20 Amp/Yellow Power Outlet
- 27 Spare
- 28 25 Amp/Clear Horn
- 29 20 Amp/Yellow Cluster, CHMSL, Stop low Lights, Anti-Lock Brake System
(ABS)
- 30 10 Amp/Red Ignition Switch
- 31 20 Amp/Yellow Hazard

34	Spare	
35	Spare	
36	20 Amp/Yellow	Electronic Automatic Transaxle (FATX) Solenoid
37	25 Amp/Clear	ASD
38	20 Amp/Yellow	Fuel Pump
39	20 Amp/Yellow	A/C Clutch, MTV
40	40 Amp/Green	Driver Door Node
41	40 Amp/Green	Passenger Door Node
42	40 Amp/Green	Front Blower
44	25 Amp/Clear	Rear Heated Seats
45	10 Amp/Red	Anti-Lock Brake System (ABS) Ignition Run
46	20 Amp/Yellow	Passenger Door
47	20 Amp/Yellow	Driver Door
48	15 Amp/Blue	PLG, OHC, Body Control Module (BCM), Navigation, Hands-Free Phone (HFM)
50	15 Amp/Blue	HVAC, DVD, RAD, CLK, SKRFFM