

FORD:

2002-2005 Explorer

LINCOLN:

2003-2005 Aviator

MERCURY:

2002-2005 Mountaineer

This article supersedes TSB **05-17-10** to update the Service Procedure.

ISSUE

Some 2002-2005 Explorer 4dr/Mountaineer and 2003-2005 Aviator vehicles may exhibit a noise from the rear wheel hub bearings. Previous service procedures required service replacement of the wheel hub bearing assembly, base part (1109). This new service procedure allows replacement at a lower service level of the wheel bearing, base part (1215) to repair the noise condition.

ACTION

Replace the rear hub bearing and wheel bearing retainer ring. Refer to the following Service Procedure.

SERVICE PROCEDURE**CAUTION**

SUSPENSION FASTENERS ARE CRITICAL. WHEN REPLACING SUSPENSION FASTENERS USE ORIGINAL EQUIPMENT FASTENERS, OR FASTENERS OF EQUIVALENT QUALITY AND DESIGN. DO NOT INSTALL A REPLACEMENT FASTENER OF LESSER QUALITY OR DIFFERENT DESIGN. PROPER TORQUE VALUES MUST BE OBSERVED DURING REASSEMBLY TO ENSURE CORRECT RETENTION OF ALL COMPONENTS. MAKE SURE THE FASTENERS ARE REINSTALLED IN THE SAME ORIENTATION AS WHEN REMOVED.

CAUTION

DO NOT LOOSEN THE AXLE WHEEL HUB RETAINER UNTIL THE WHEEL AND TIRE ARE REMOVED FROM THE VEHICLE. WHEEL BEARING DAMAGE WILL OCCUR IF THE WHEEL BEARING IS UNLOADED WITH THE WEIGHT OF THE VEHICLE APPLIED.

NOTE

HAVE AN ASSISTANT PRESS THE BRAKE PEDAL TO KEEP THE AXLE FROM TURNING.

1. Remove the axle-to-wheel hub retainer nut and washer (Figure 1). Discard the nut. When reinstalling at end of procedure, tighten to 203 lb-ft (275 N•m).

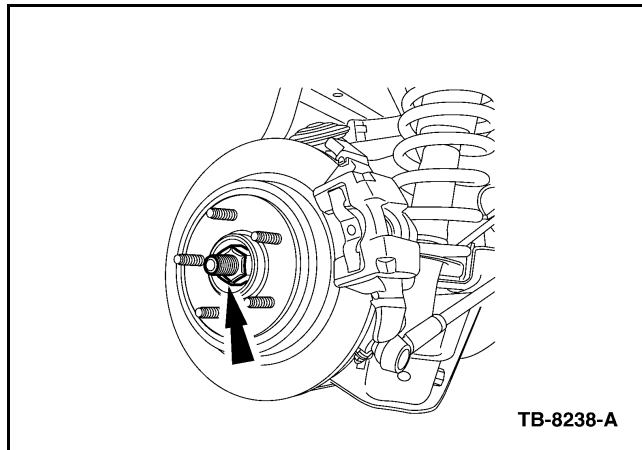

Figure 1 - Article 05-25-8

2. Remove the bolt and disconnect the wheel speed sensor (Figure 2). To install, tighten to 71 lb-in (8 N•m).

NOTE: The information in Technical Service Bulletins is intended for use by trained, professional technicians with the knowledge, tools, and equipment to do the job properly and safely. It informs these technicians of conditions that may occur on some vehicles, or provides information that could assist in proper vehicle service. The procedures should not be performed by "do-it-yourselfers". Do not assume that a condition described affects your car or truck. Contact a Ford, Lincoln, or Mercury dealership to determine whether the Bulletin applies to your vehicle. Warranty Policy and Extended Service Plan documentation determine Warranty and/or Extended Service Plan coverage unless stated otherwise in the TSB article. The information in this Technical Service Bulletin (TSB) was current at the time of printing. Ford Motor Company reserves the right to supersede this information with updates. The most recent information is available through Ford Motor Company's on-line technical resources.

TSB 05-25-8 (Continued)

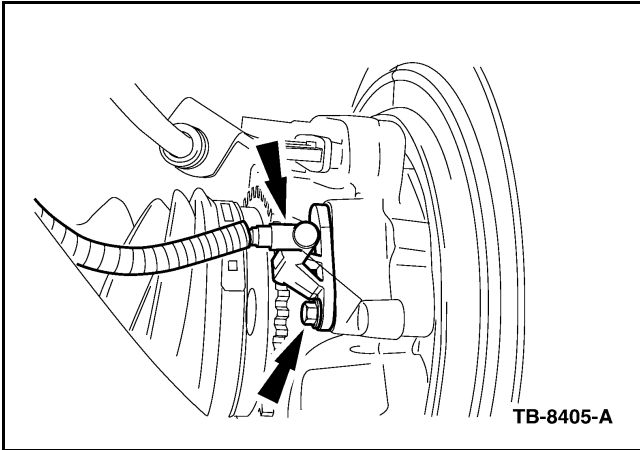

Figure 2 - Article 05-25-8

3. Remove the parking brake shoes. For additional information, refer to Workshop Manual, Section 206-05.
4. Remove and discard the toe link-to-wheel knuckle nut. To install, tighten to 66 lb-ft (90 N•m).

CAUTION
DO NOT DAMAGE THE BOOT WHILE SEPARATING THE TOE LINK FROM THE WHEEL KNUCKLE.

5. Remove the bolt and separate the toe link from the wheel knuckle.
6. Remove and discard the upper arm-to-wheel knuckle nut. To install, tighten to 66 lb-ft (90 N•m).

CAUTION
DO NOT DAMAGE THE BOOT WHILE SEPARATING THE BALL JOINT FROM THE WHEEL KNUCKLE.

7. Remove the bolt and separate the upper arm from the wheel knuckle.
8. Using the Special Tool 205-D070 (D93P-1175-B), or equivalent, press the outboard CV joint until it is loose from the hub (Figure 3).

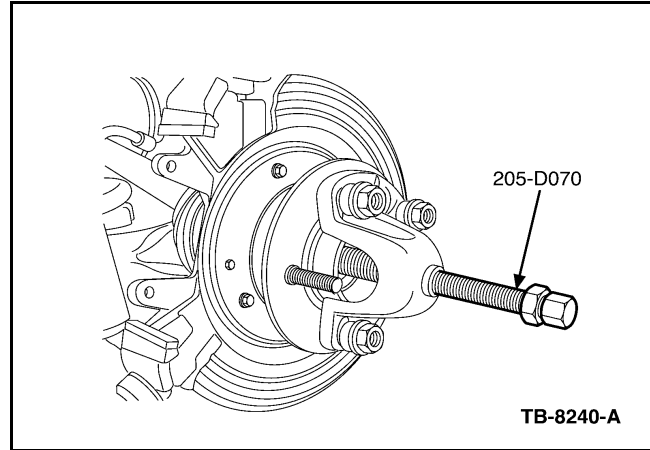

Figure 3 - Article 05-25-8

9. Remove and discard the lower arm-to-wheel knuckle nut. To install, tighten to 111 lb-ft (150 N•m).
10. Remove the lower arm-to-wheel knuckle bolt.
11. Remove the wheel knuckle.
12. Remove the three (3) brake disc shield-to-wheel knuckle bolts (Figure 4). To install, tighten to 10 lb-ft (13N•m)

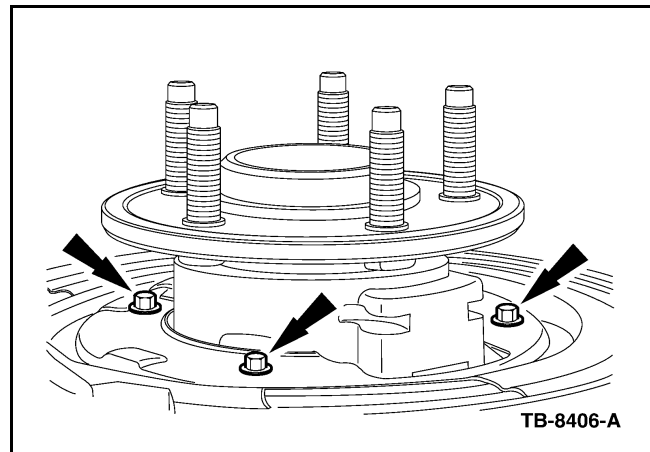

Figure 4 - Article 05-25-8

13. Using a suitable press, remove the wheel hub (Figure 5).

TSB 05-25-8 (Continued)

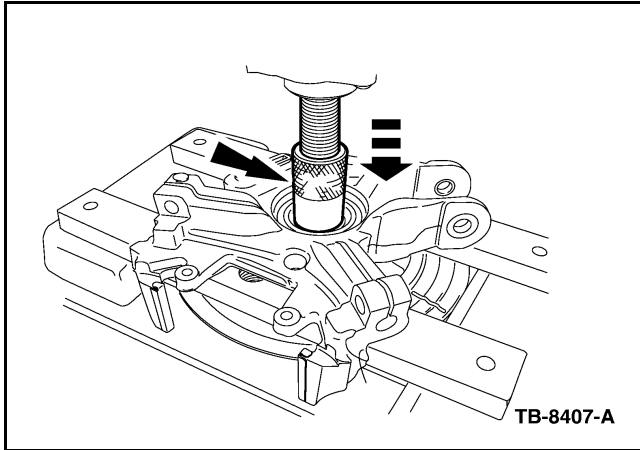

Figure 5 - Article 05-25-8

14. Remove the brake disc shield.

NOTE

THIS STEP MAY NOT BE NECESSARY IF THE INNER WHEEL BEARING RACE REMAINS IN THE WHEEL KNUCKLE AFTER REMOVING THE WHEEL HUB.

15. Using Special Tool 205-D002, or equivalent, press the inner wheel bearing race from the wheel hub (Figure 6).

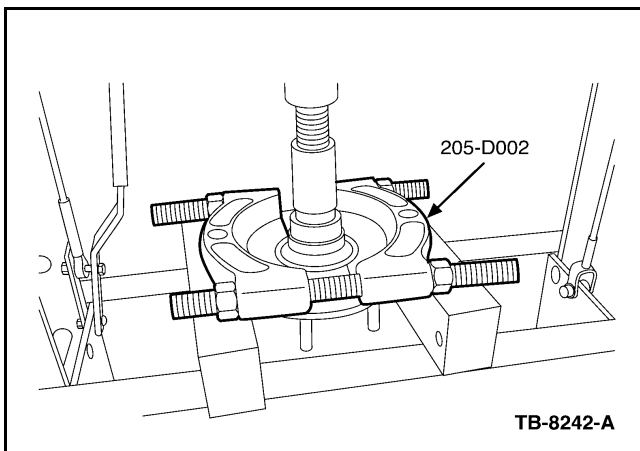

Figure 6 - Article 05-25-8

16. Remove the wheel bearing retainer ring.
17. Using a suitable press, remove and discard the wheel bearing.
18. To install, reverse the removal procedure.

NOTE

DURING REASSEMBLY ALWAYS INSTALL NEW:

- AXLE-TO-WHEEL HUB RETAINER NUT
- TOE LINK-TO-WHEEL KNUCKLE NUT
- UPPER ARM-TO-WHEEL KNUCKLE NUT
- LOWER ARM-TO-WHEEL KNUCKLE NUT
- WHEEL BEARING

REFER TO PART CATALOG FOR CORRECT APPLICATION AND PART NUMBER.

PART NUMBER	PART NAME
3L2Z-1215-AA	Rear Wheel Bearing
5L2Z-1A124-A	Snap Ring

WARRANTY STATUS: Eligible Under Provisions Of New Vehicle Limited Warranty Coverage

OPERATION	DESCRIPTION	TIME
052508A	2002-2005 Explorer/Mountaineer 2003-2005 Aviator: Replace One Rear Wheel Bearing (Do Not Use With 1225A, 1225AT)	1.5 Hrs.
052508B	2002-2005 Explorer/Mountaineer 2003-2005 Aviator: Replace Both Rear Wheel Bearings (Do Not Use With 1225A, 1225AT)	2.7 Hrs.

DEALER CODING

BASIC PART NO.	CONDITION CODE
1215	30