

**REMOVAL**

1. Raise vehicle on a hoist.
2. Remove wheel and tire.
3. Remove splash shield as necessary to access headlamp housing. See **Fig. 10**.
4. Remove grille.
5. Remove the two fascia bolts from behind the grille. See **Fig. 19**.

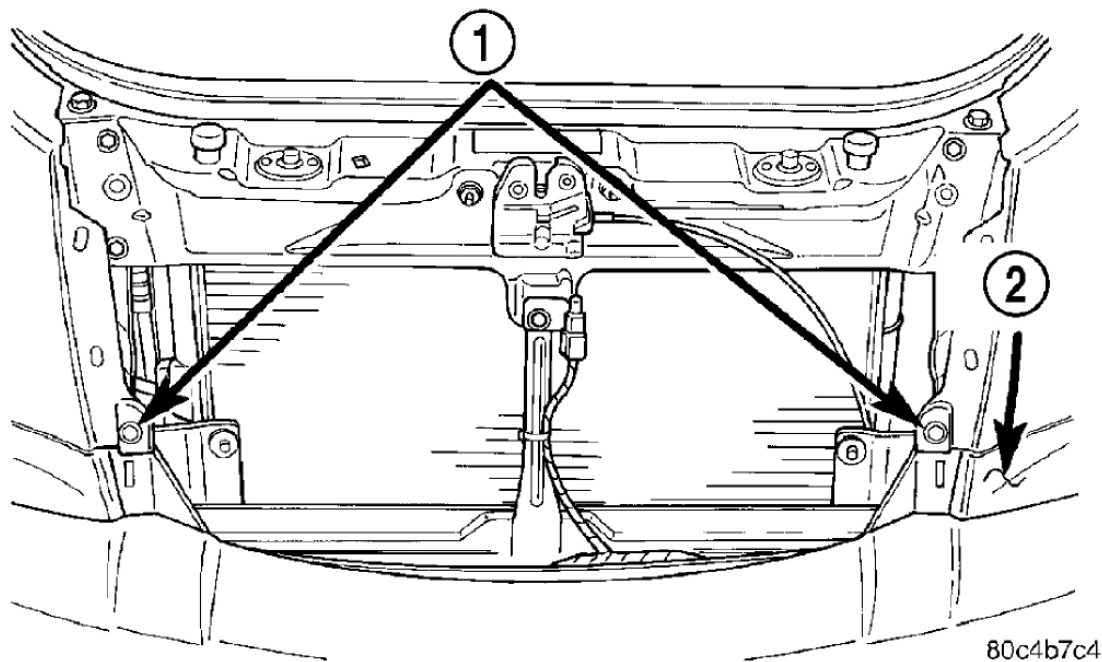

**Fig. 19: Fascia Center Attaching Point**  
Courtesy of DAIMLERCHRYSLER CORP.

1 - ATTACHING POINTS 2 - FRONT FASCIA
--

6. Remove fasteners attaching fender to fascia on the side being worked on.
7. Remove the three fasteners holding the lower fascia (3) to the lower radiator crossmember.

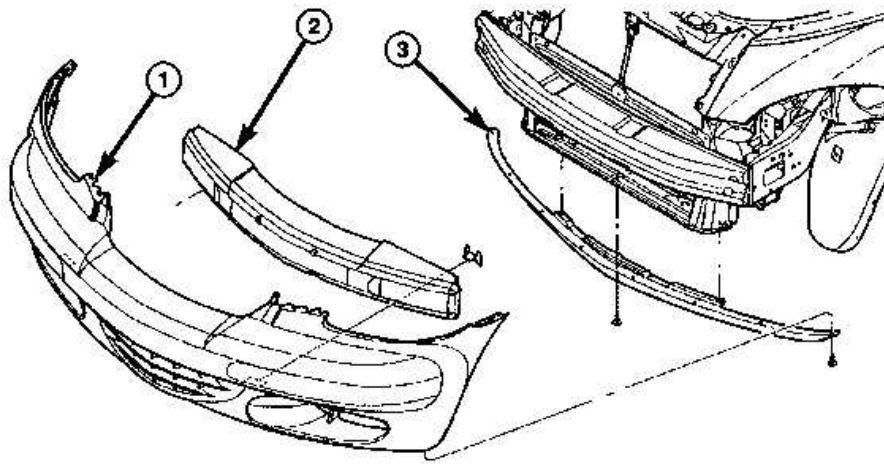

60006e6d

**Fig. 20: Locating Fasteners At Lower Fascia**  
Courtesy of DAIMLERCHRYSLER CORP.

8. Make sure there is a slight gap (1) between the fender and fascia.

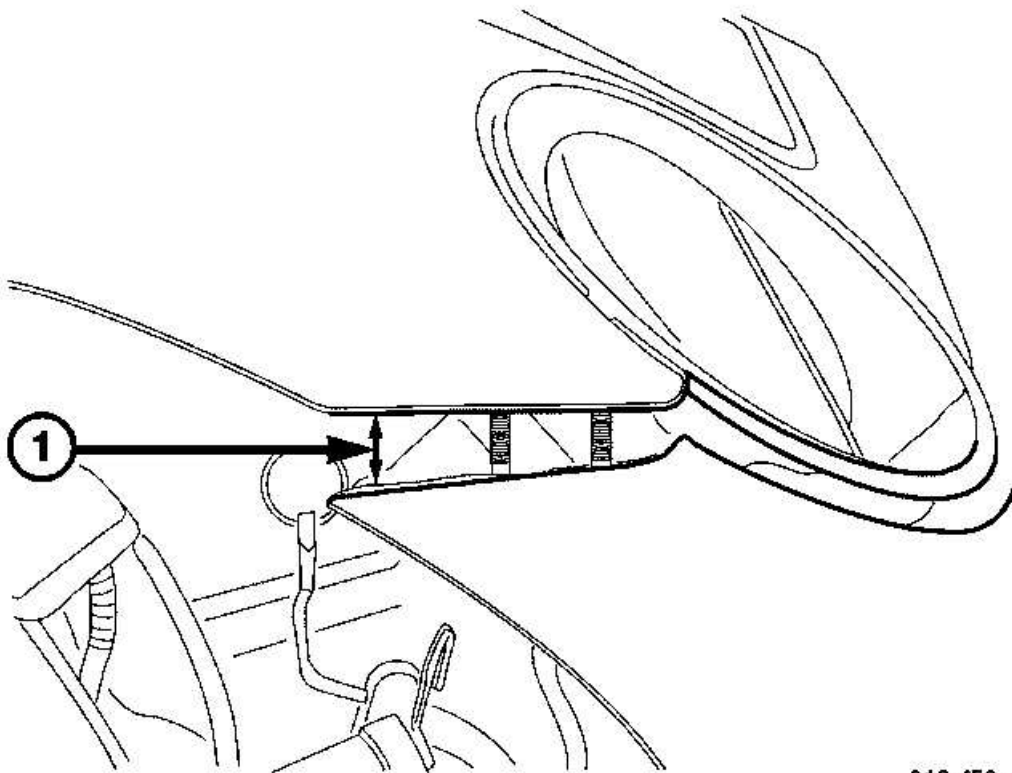

816ef50a

**Fig. 21: Locating Gap Between Fender And Fascia**  
Courtesy of DAIMLERCHRYSLER CORP.

9. Disconnect wire connectors (2, 5, and 7).
10. Remove four nuts (1, 3, and 6) attaching headlamp housing (4).

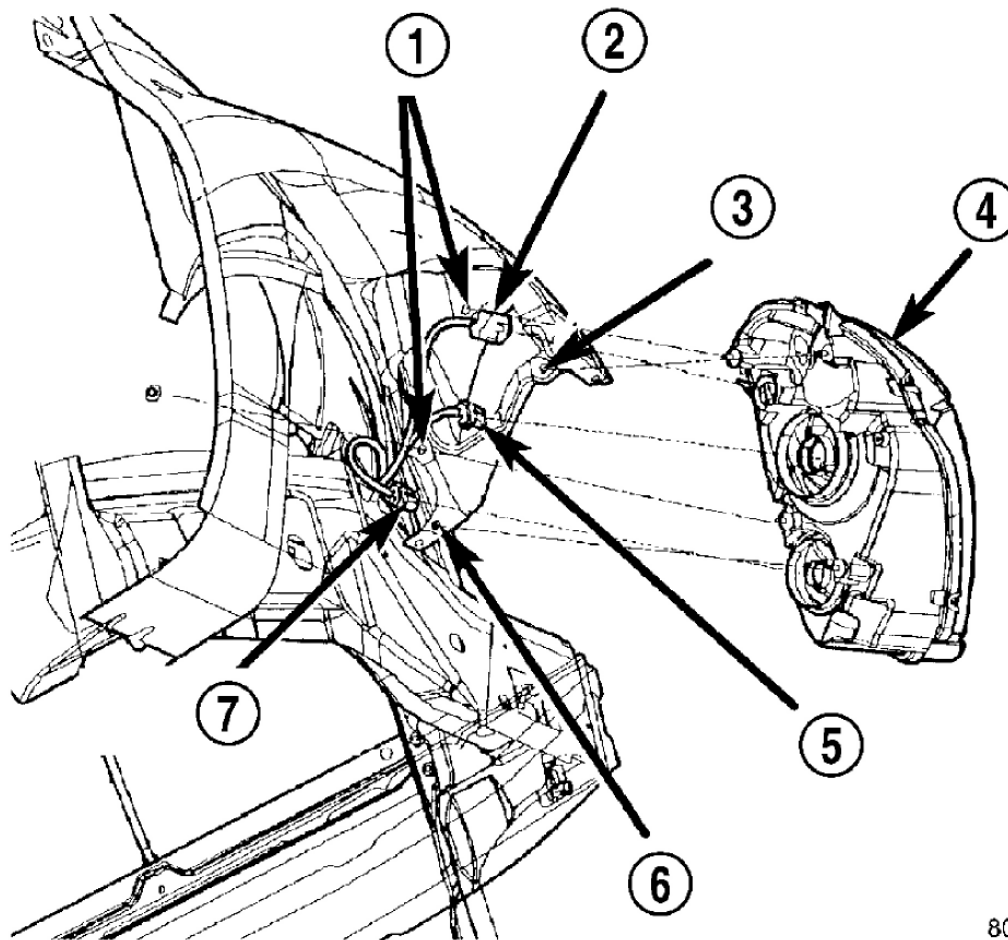

80c4b763

**Fig. 22: Headlamp Unit Removal**

Courtesy of DAIMLERCHRYSLER CORP.

- |   |
|---|
| 1 - MOUNTING HOLES<br>2 - FRONT SIDE MARKER/PARK/TURN SIGNAL LAMP<br>3 - MOUNTING HOLES<br>4 - HEADLAMP HOUSING<br>5 - LOW BEAM CONNECTOR<br>6 - MOUNTING HOLE<br>7 - HIGH BEAM CONNECTOR |
|---|

- Once the fascia (3) is loosened on the appropriate side and there is a gap between the fascia and the headlamp unit (1), place a shop towel underneath the headlamp unit (2) on the fascia (3) to protect it from scratches and marring.
- Tilt the bottom of the headlamp unit (1) forward and then pull straight out of fender/fascia opening, taking care not to damage headlamp unit, fender, or fascia (2).

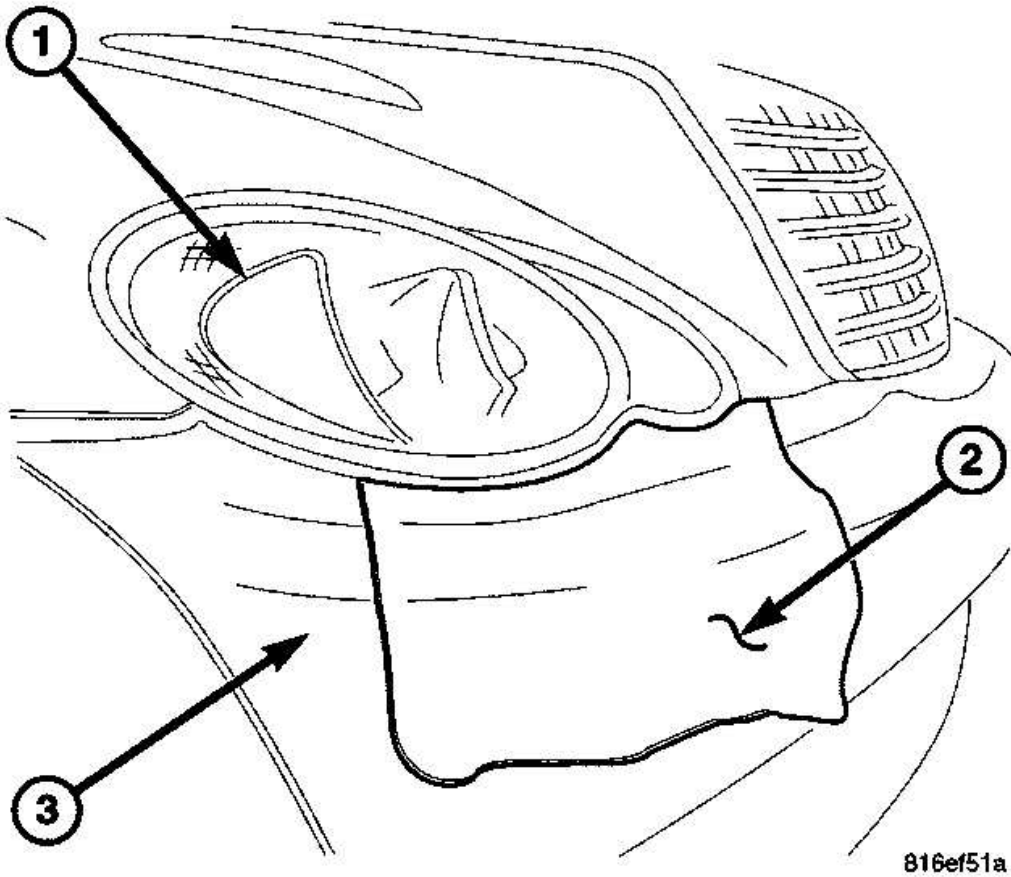

**Fig. 23: Locating Shop Towel Underneath Headlamp Unit**  
Courtesy of DAIMLERCHRYSLER CORP.

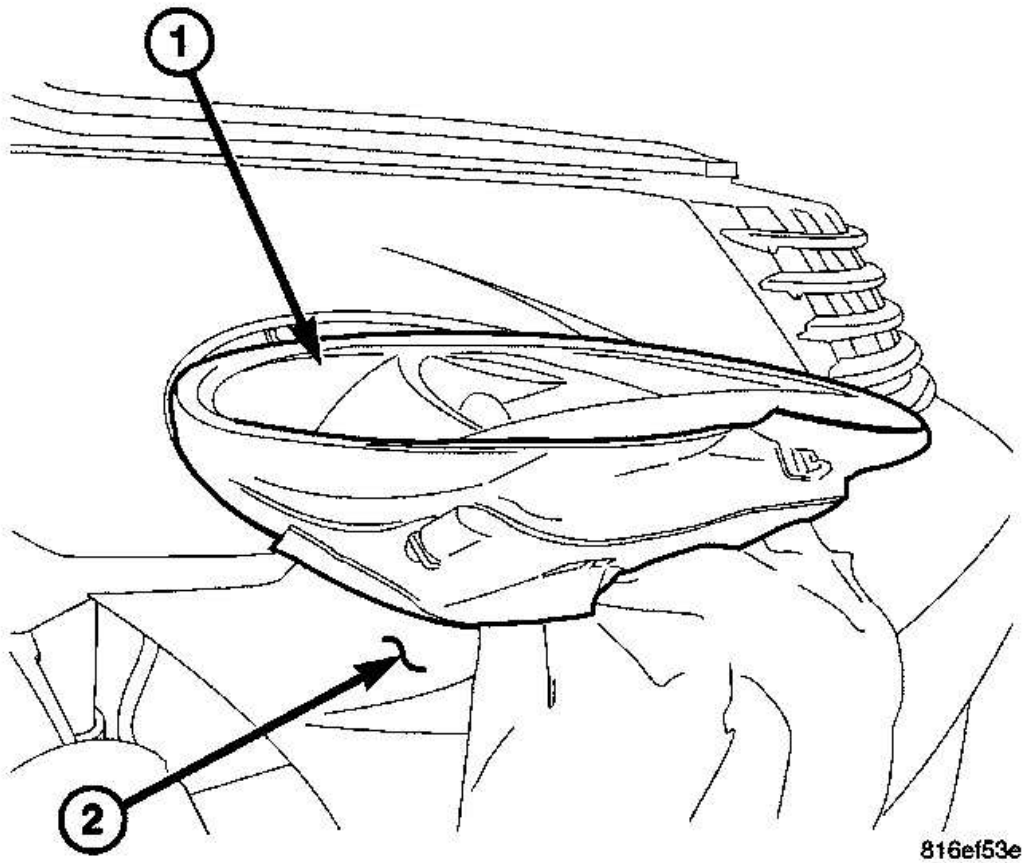

**Fig. 24: Tilting Headlamp Unit**  
Courtesy of DAIMLERCHRYSLER CORP.