

2002 Chrysler PT Cruiser

2002-04 SUSPENSION Front - PT Cruiser

1. Raise the vehicle.
2. Remove tire and wheel assembly.
3. If both strut assemblies are to be removed, mark the strut assemblies right or left according to which side of the vehicle they were removed from.
4. Remove the screw securing the ground strap to the rear of the strut. See [Fig. 36](#) .
5. If the vehicle is equipped with Anti-Lock Brakes System. (ABS), remove the screw securing the ABS Wheel Speed Sensor (WSS) to the rear of the strut. See [Fig. 36](#) .

CAUTION: The strut assembly-to-steering knuckle attaching bolts are serrated and must not be turned during removal. Hold the bolts stationary in the steering knuckle while removing the nuts, then tap the bolts out using a pin punch.

6. Remove the 2 bolts attaching the strut to the steering knuckle. See [Fig. 1](#) .
7. Lower the vehicle just enough to open the hood, but without letting the tires touch the floor.
8. Remove the 3 nuts attaching the upper mount of the strut assembly to the vehicle's strut tower. See [Fig. 37](#) .
9. Remove the strut assembly from the vehicle.
10. For disassembly, see [DISASSEMBLY](#) .

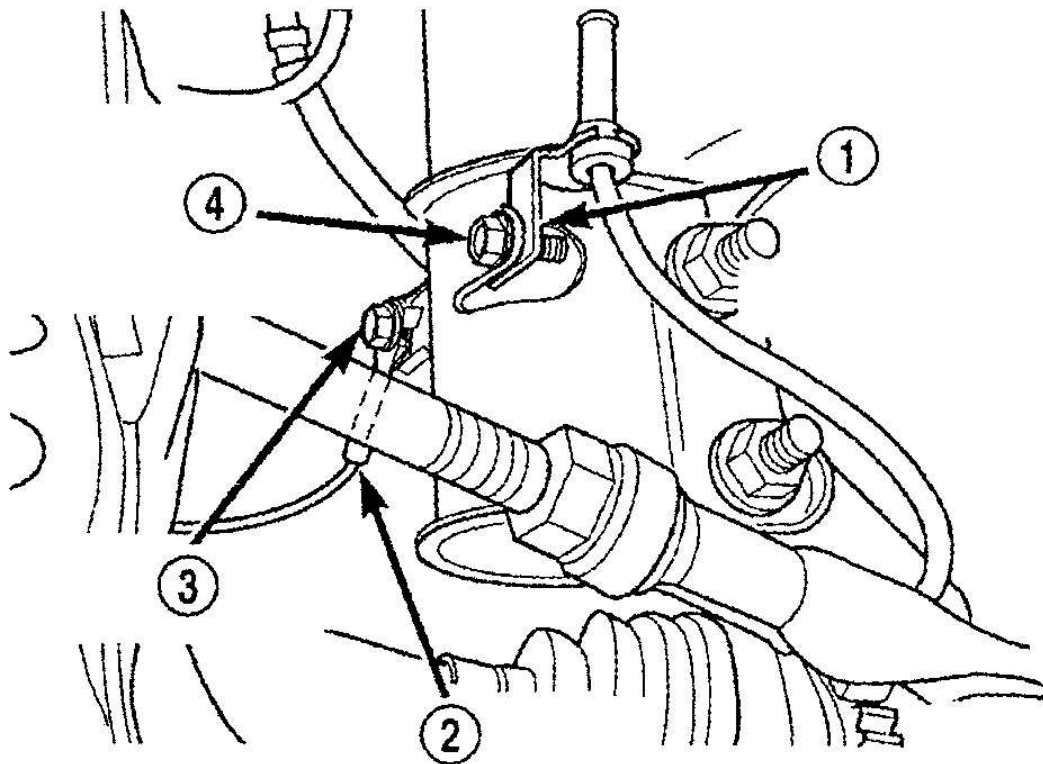

- 1 - ABS WHEEL SPEED SENSOR ROUTING BRACKET (IF EQUIPPED)
- 2 - GROUND STRAP
- 3 - GROUND STRAP SCREW
- 4 - ABS SENSOR BRACKET SCREW (IF EQUIPPED)

G00377969

Fig. 36: Locating Ground Strap & ABS Sensor Bracket
Courtesy of DAIMLERCHRYSLER CORPORATION

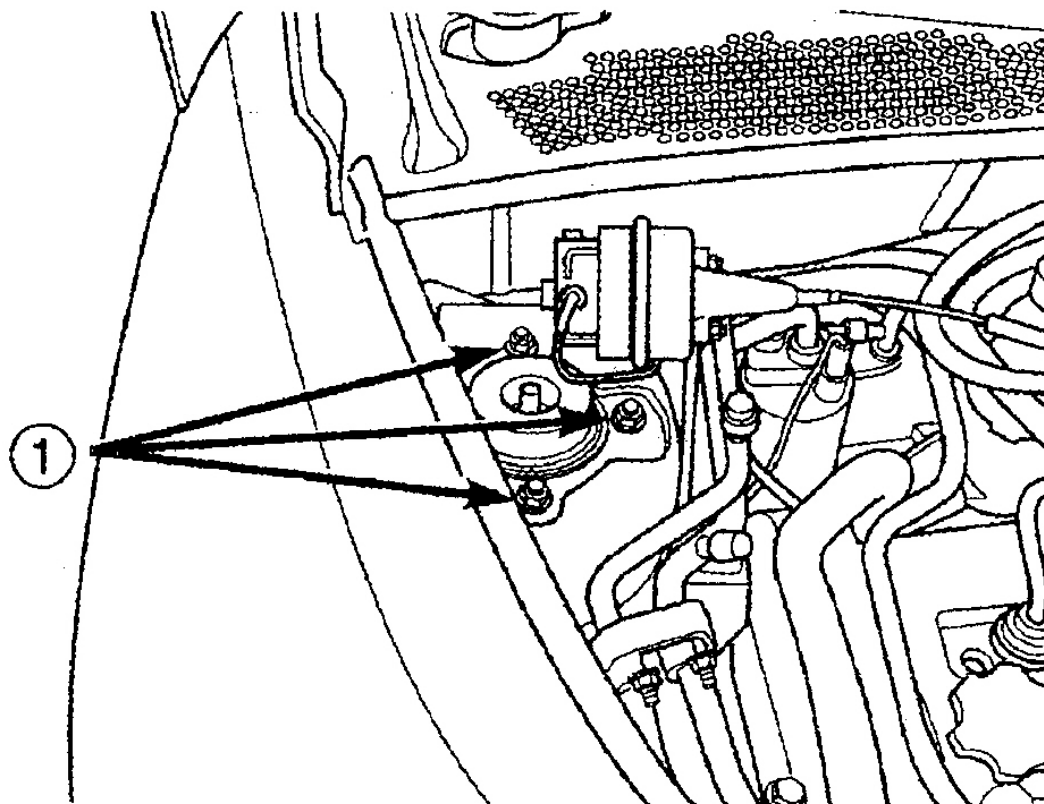

1 - NUTS

G00377970

Fig. 37: Locating Upper Mount Nuts

Courtesy of DAIMLERCHRYSLER CORPORATION

Disassembly

The Strut assembly must be removed from the vehicle for it to be disassembled and assembled. See **REMOVAL**.

For the disassembly and assembly of the strut assembly, use strut spring compressor, Pentastar Service Equipment (PSE) tool W-7200, or the equivalent, to compress the coil spring. Follow the manufacturer's instructions closely.

1. If both struts are being serviced at the same time, mark the coil spring and strut assembly according to which side of the vehicle the strut was removed from, and which strut the coil spring was removed from.
2. Position the strut assembly in the strut coil spring compressor following the manufacturer's instructions. Set the lower hooks. See **Fig. 38**. Set the upper hooks. See **Fig. 39**. Position the strut clevis bracket straight outward away from the compressor. Place a clamp on the lower end of the coil spring, so the strut

is held in place once the strut shaft nut is removed. See [Fig. 38](#) .

WARNING: DO NOT remove the strut shaft nut before the coil spring is compressed. The coil spring is held under pressure and must be compressed, removing spring tension from the upper mount and pivot bearing, before the shaft nut is removed.

3. Compress the coil spring until all coil spring tension is removed from the upper mount.

CAUTION: Never use impact or high speed tools to remove the strut shaft nut. Damage to the strut internal bearings may occur.

4. Once the spring is sufficiently compressed, install Strut Nut Socket, Special Tool 6864, on the strut shaft retaining nut. See [Fig. 40](#) . Next, install a socket on the hex on the end of the strut shaft. While holding the strut shaft from turning, remove the nut from the strut shaft.
5. Remove the upper mount from the strut shaft. See [Fig. 3](#) .
6. Remove the upper spring seat and bearing, along with the upper spring isolator as an assembly from the top of the coil spring by pulling them straight up. See [Fig. 3](#) . The upper spring isolator can be separated from the spring seat and bearing once removed from vehicle.
7. Remove the dust shield, then the jounce bumper from the strut shaft by pulling each straight up. See [Fig. 3](#) .
8. Remove the clamp from the bottom of the coil spring and remove the strut out through the bottom of the coil spring.
9. Remove the lower spring isolator from the lower spring seat on the strut.

NOTE: If the coil spring needs to be serviced, proceed with this step, otherwise, proceed with step 11 .

10. Release the tension from the coil spring by backing off the compressor drive completely. Push back the compressor hooks and remove the coil spring.
11. Inspect the strut assembly components for the following and replace as necessary:
 - Inspect the strut for any condition of shaft binding over the full stroke of the shaft.
 - Inspect the jounce bumper for cracks and signs of deterioration.
 - Check the upper mount for cracks and distortion and its retaining studs for any sign of damage.
 - Check the upper spring seat and bearing for cracks and distortion.
 - Check for binding of the upper spring seat and bearing pivot bearing.
 - Inspect the dust shield for rips and deterioration.
 - Inspect the upper and lower spring isolators for material deterioration and distortion.
 - Inspect the coil spring for any sign of damage to the coating.

NOTE: For reassembly, see [ASSEMBLY](#) .

2002 Chrysler PT Cruiser

2002-04 SUSPENSION Front - PT Cruiser

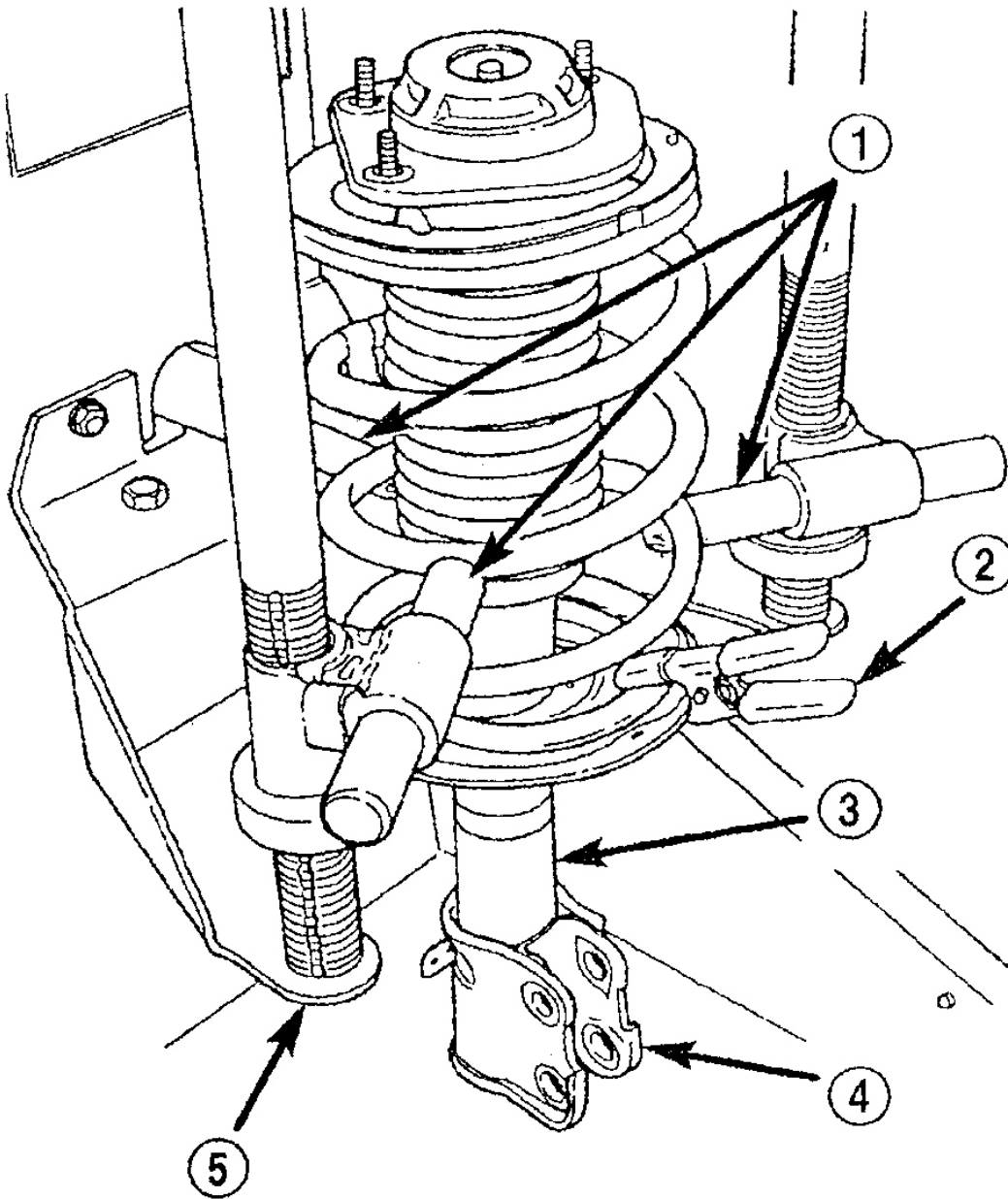

- 1 - LOWER HOOKS
- 2 - CLAMP
- 3 - STRUT ASSEMBLY
- 4 - CLEVIS BRACKET
- 5 - SPRING COMPRESSOR

G00377971

Fig. 38: Setting Lower Compressor Hooks
Courtesy of DAIMLERCHRYSLER CORPORATION

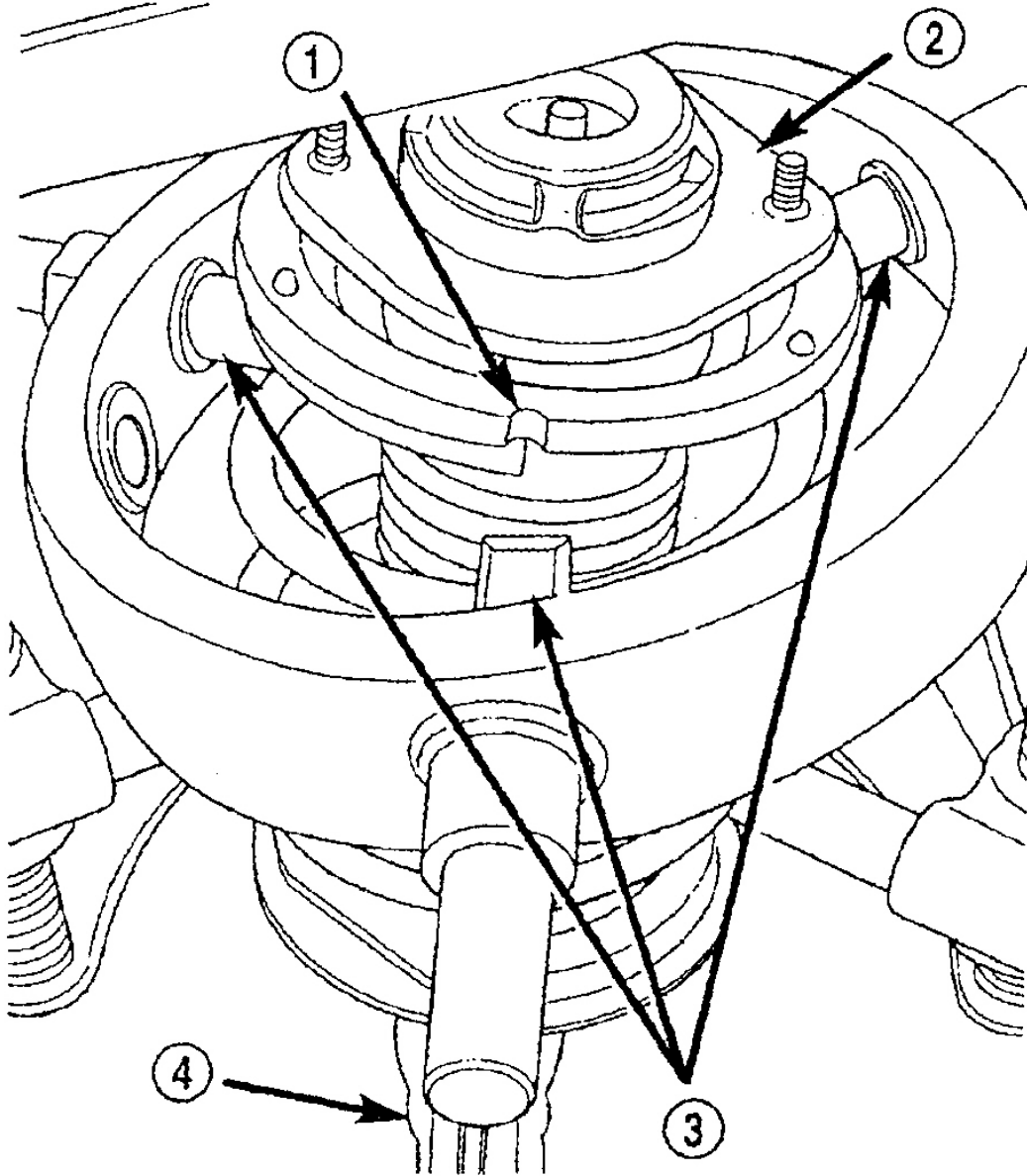

- 1 - NOTCH IN UPPER SEAT
- 2 - UPPER MOUNT
- 3 - UPPER HOOKS
- 4 - CLEVIS BRACKET

G00377972

Fig. 39: Setting Upper Compressor Hooks

Courtesy of DAIMLERCHRYSLER CORPORATION

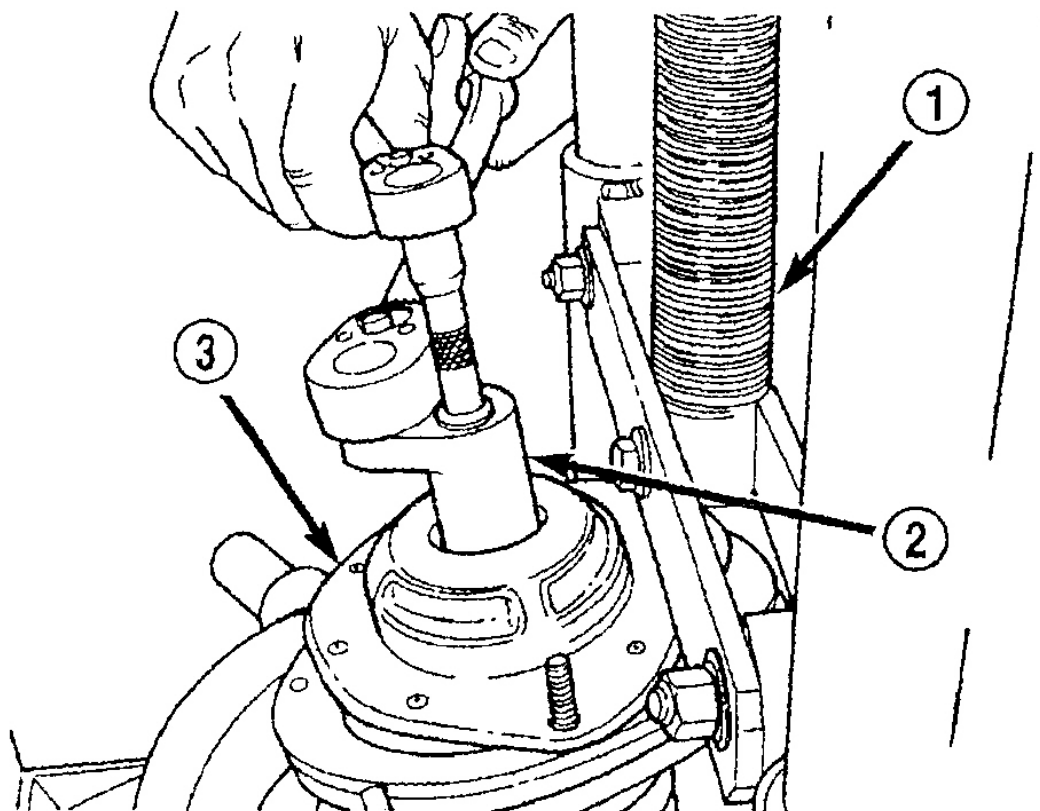

- 1 - SPRING COMPRESSOR
- 2 - SPECIAL TOOL 6864
- 3 - UPPER MOUNT

G00377973

Fig. 40: Removing & Installing Shaft Nut

Courtesy of DAIMLERCHRYSLER CORPORATION