

POWER WINDOW MOTOR

NOTE: This procedure also covers condition where power window cables become disconnected.

Removal

Remove window regulator. See [WINDOW REGULATOR](#) . Remove 2 screws attaching metal cover to power window motor. Remove drum, guide and cables from power window motor. See [Fig. 19](#) .

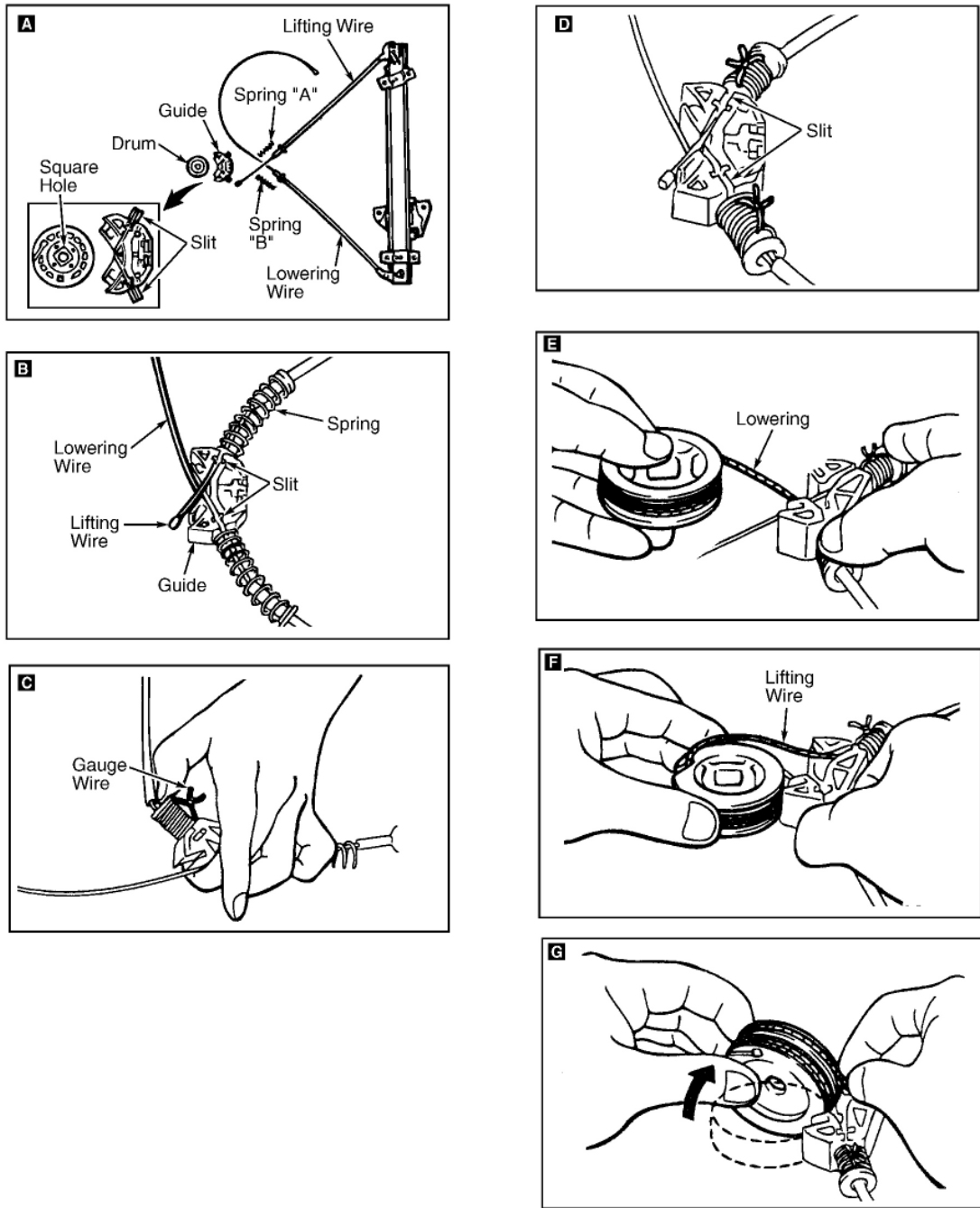

G00023713

Fig. 19: Removing & Installing Power Window Motor
 Courtesy of DAIMLERCHRYSLER CORPORATION

Installation

1. Connect power window motor connector. Turn ignition on. Pull up on power window switch button until power window motor stops. Turn ignition off. Disconnect power window motor connector.

2. Align drum with power window motor square drive using a 1/2" ratchet. See [Fig. 19](#) . Hold drum and guide assembly in hand when aligning or cables may pull out of drum. When aligning drum, ensure glass bracket is within specified distance from end of regulator. See [Fig. 19](#) . If cables pull out of drum, go to next step. If cables do not pull out of drum, go to step 6 .
3. Place drum, guide and regulator on bench as shown in step "A". See [Fig. 20](#) . Place drum with square hole facing upward. Place guide with slits facing upward. Place regulator with glass bracket facing down. Place glass bracket in open position on regulator.
4. Place springs over the cable housings then install cables into guide, making sure lowering (longer) cable is installed first as shown in step "B". Compress springs and tie in compressed positions using wire as shown in steps "C and "D".
5. Insert lowering (longer) cable into hole at bottom of drum. Wrap cable around bottom of drum until all slack is gone as shown in step "E". Insert lifting (shorter) cable into hole at top of drum as shown in step "F". Raise front drum to vertical position and install lifting cable into upper drum groove as shown in step "G".
6. Hold wires onto drum. Reconnect drum and guide assembly to power window motor. Install metal cover over guide and attach to motor. To complete installation, reverse removal procedure.

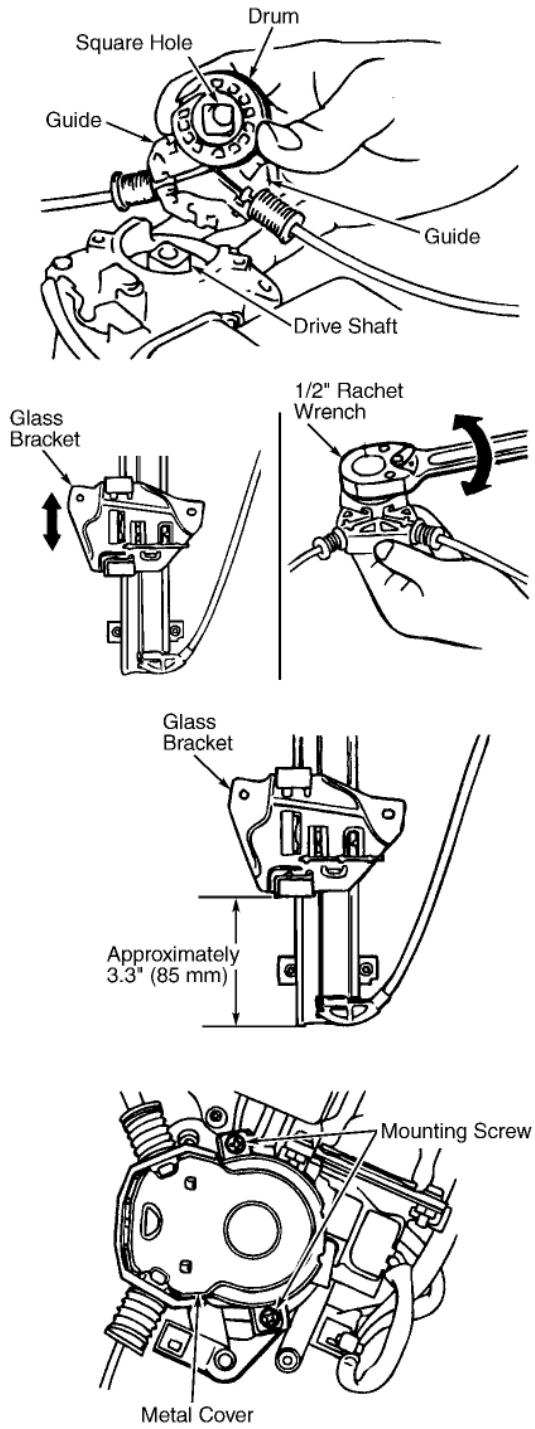

G00023717

Fig. 20: Installing Power Window Drive Cables
Courtesy of DAIMLERCHRYSLER CORPORATION

POWER WINDOW SWITCH

Removal & Installation

Pry rear edge of power window switch assembly upward to release clip. Slide switch rearward to remove from door panel. Disconnect electrical connector. To install, reverse removal procedure.

WINDOW REGULATOR

Removal & Installation

Remove door trim panel and watershield. See [DOOR TRIM PANEL & WATERSHIELD](#) . Remove belt line molding. See [Fig. 21](#) . Remove up-stop bolts. See [Fig. 22](#) . Remove delta sash. Remove glass retaining screws and glass. Remove window regulator bolts. Remove window regulator and motor as an assembly. To install, reverse removal procedure.

2001 Chrysler Sebring LX

2001 ACCESSORIES & EQUIPMENT Power Windows - Sebring Coupe & Stratus Coupe

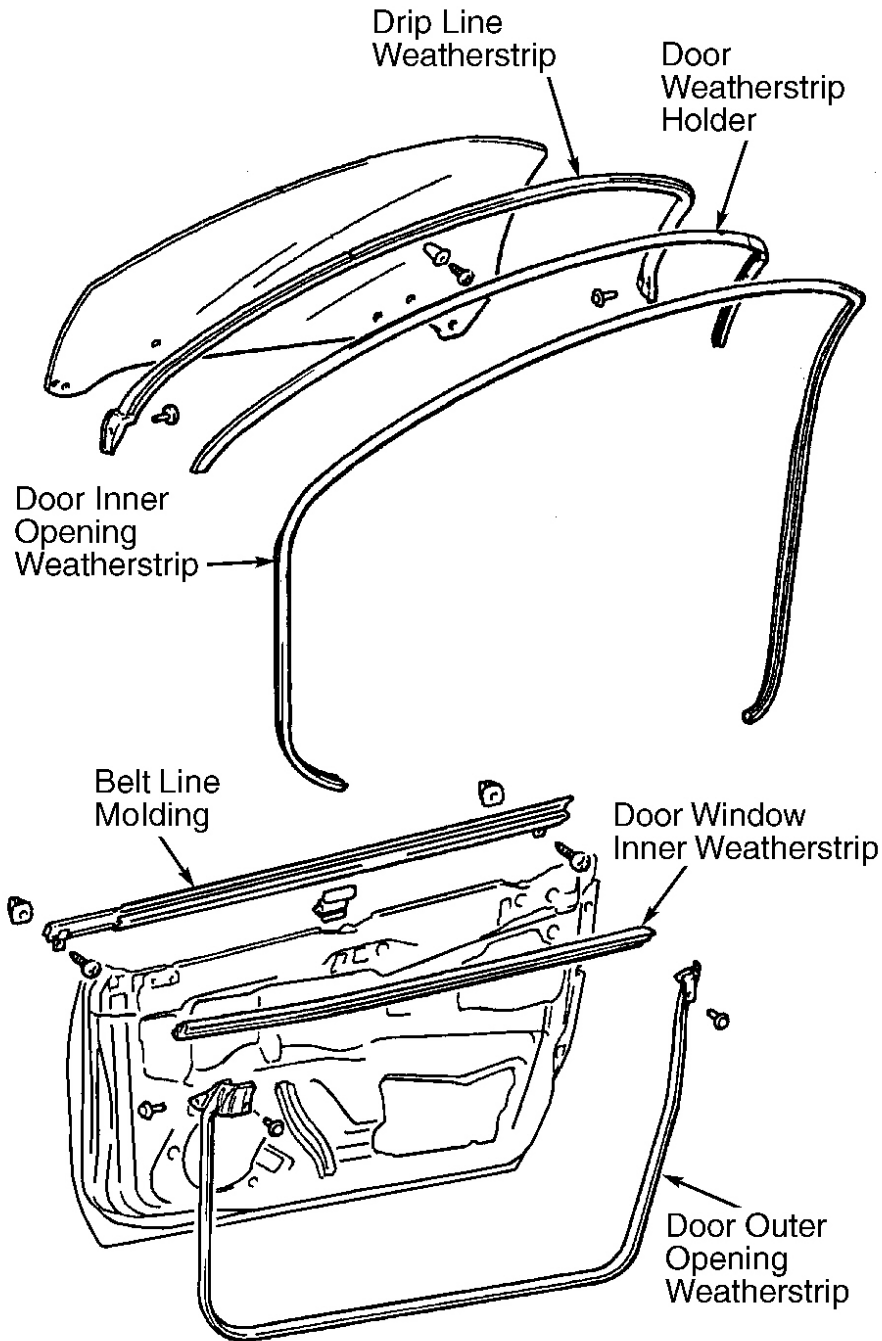

G00007322

Fig. 21: Identifying Door Weatherstrip & Moldings
Courtesy of DAIMLERCHRYSLER CORP.

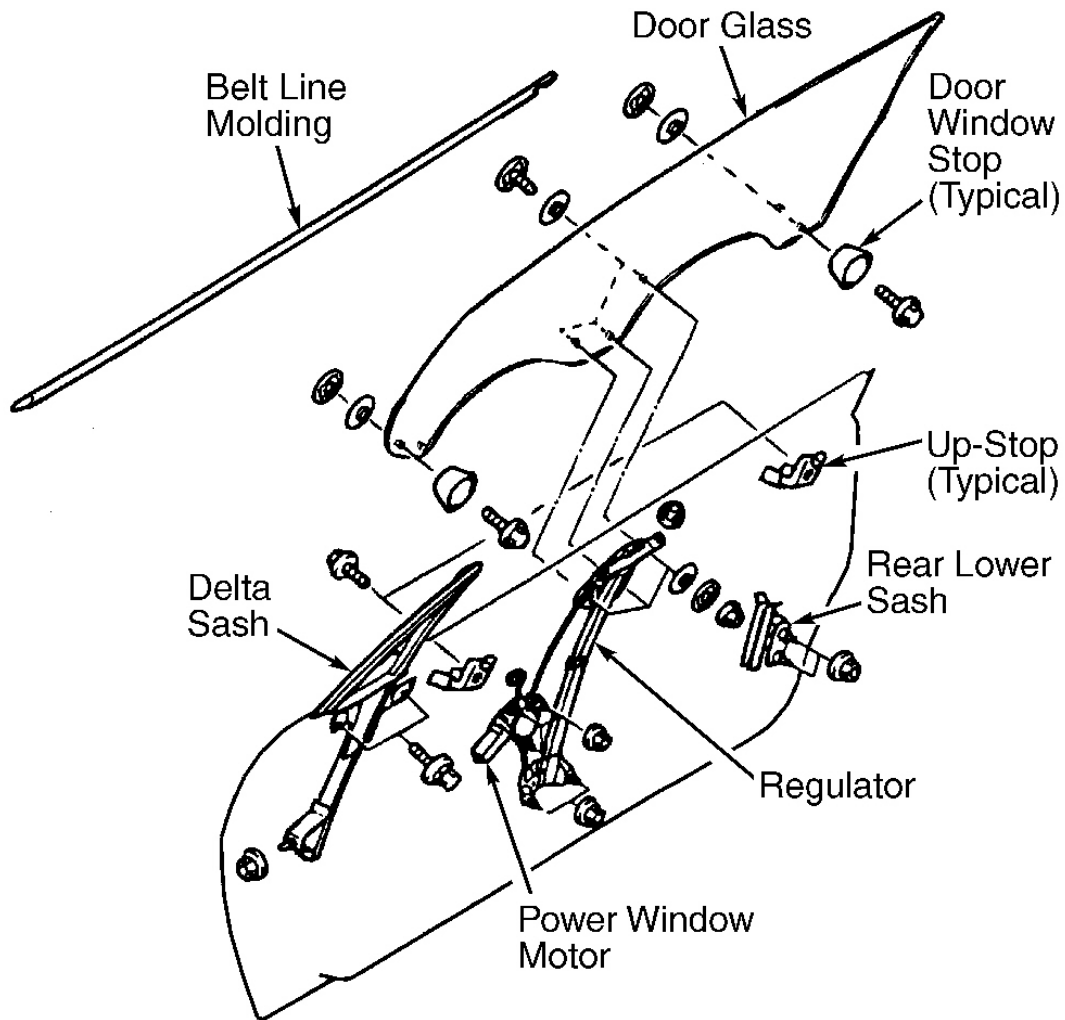

G00023709

Fig. 22: Removing Door Glass & Regulator
Courtesy of DAIMLERCHRYSLER CORPORATION