

MULTIFUNCTION, TURN SIGNAL SWITCH REPLACEMENT

Removal Procedure

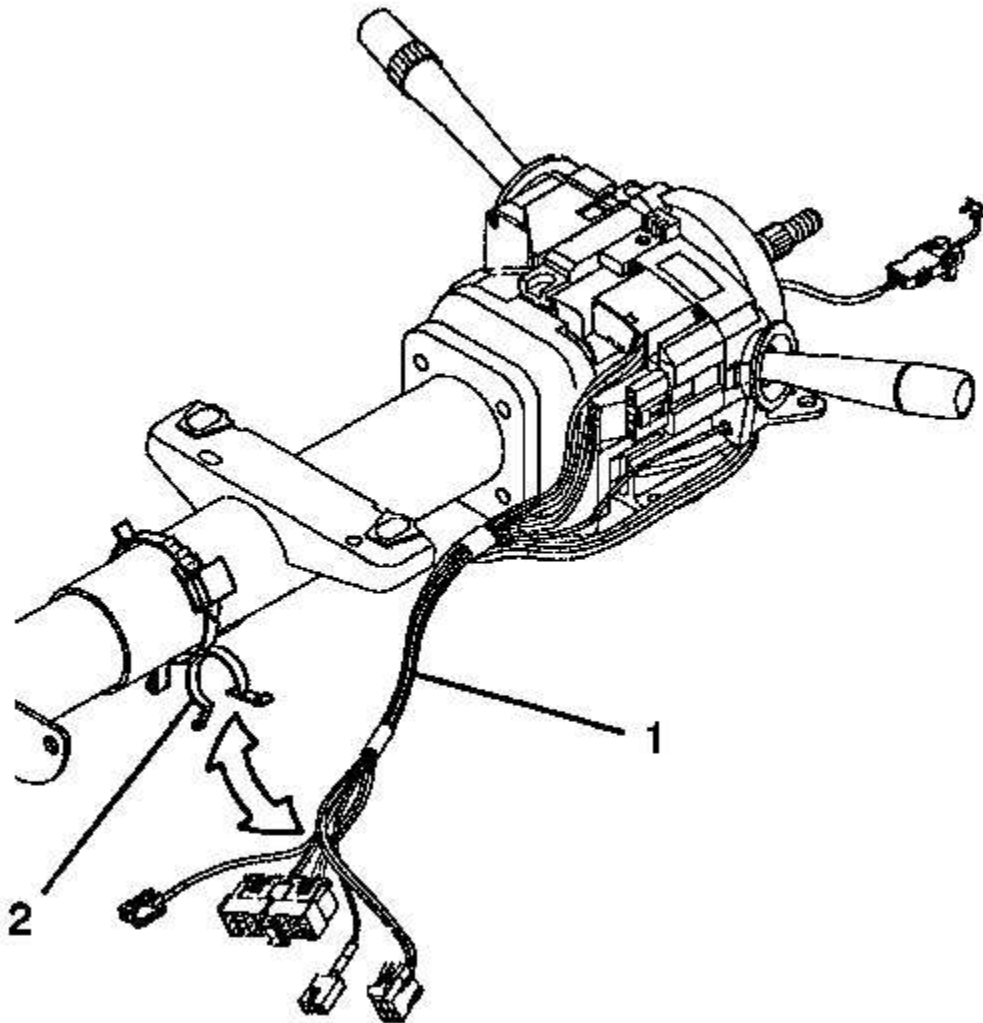

Fig. 28: View Of Steering Column Wire Harness Assembly & Wire Harness Strap
Courtesy of GENERAL MOTORS CORP.

CAUTION: Refer to SIR Caution in Cautions and Notices.

1. Disable the SIR system. Refer to [SIR Disabling and Enabling Zone 3](#) in SIR.
2. Remove the upper and lower trim covers. Refer to [Steering Column Trim Covers Replacement](#).

IMPORTANT: The abrasion sleeve located on the steering column wire harness assembly must be reinstalled. Make note of what connector is coming out of the abrasion sleeve for installation purposes.

3. Remove the wire harness assembly (1) from the wire harness strap (2).
4. Disconnect the turn signal and multifunction switch assembly connector from the SIR system coil connector.

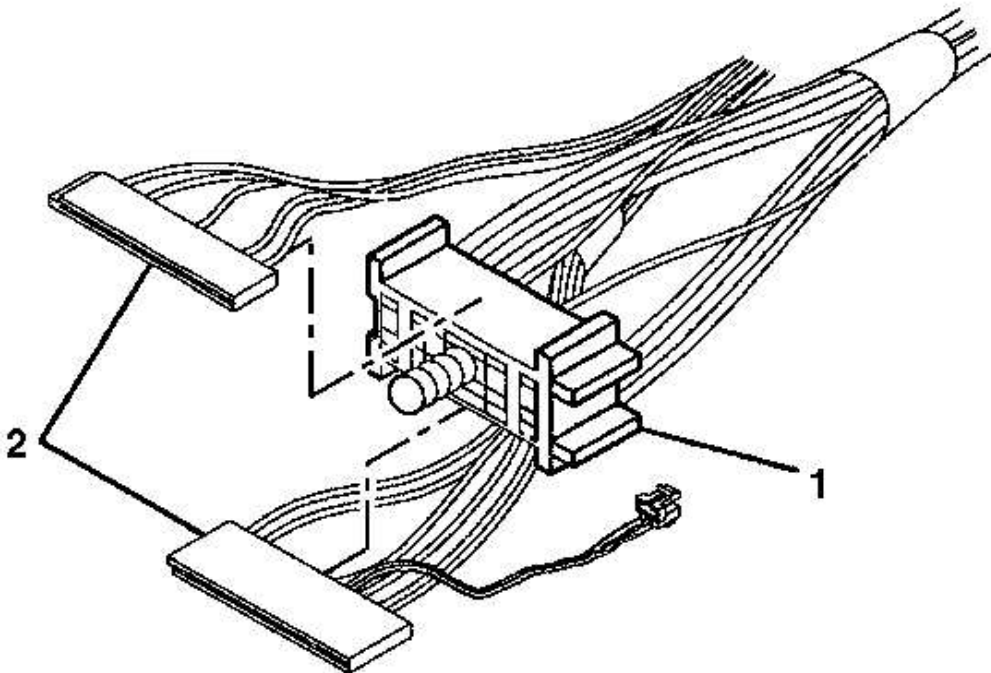

Fig. 29: Turn Signal & Multifunction Switch Assembly Connectors
Courtesy of GENERAL MOTORS CORP.

5. Slide the 2 connectors (2) of the turn signal and multifunction switch assembly out of the bulkhead connector (1).

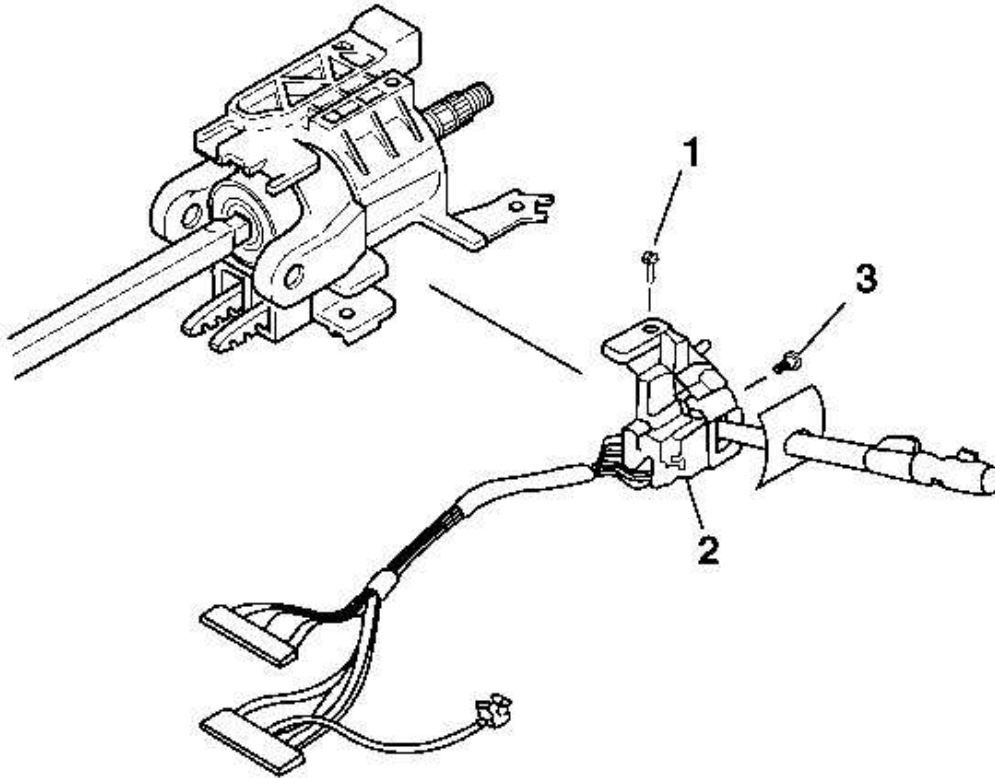

Fig. 30: View Of Turn Signal & Multifunction Switch Assembly
Courtesy of GENERAL MOTORS CORP.

6. Remove the 2 pan head tapping screws (1) and (3) from the turn signal and multifunction switch assembly (2).
7. Remove the turn signal and multifunction switch assembly (2) from the steering column tilt head assembly.

Installation Procedure

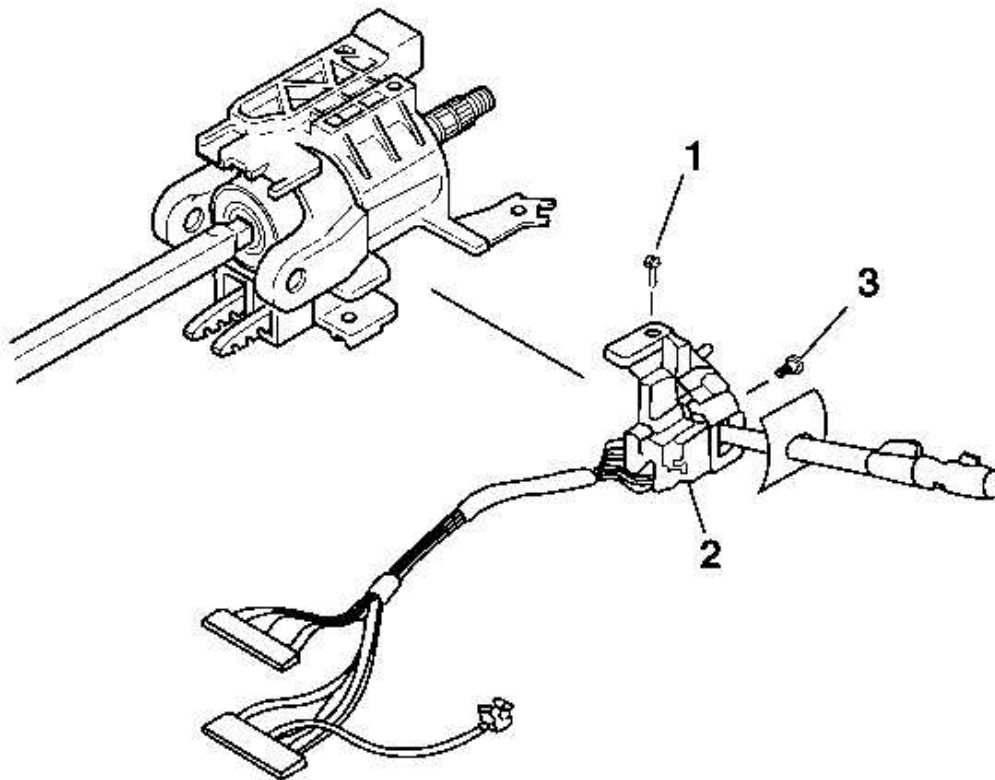

Fig. 31: View Of Turn Signal & Multifunction Switch Assembly
Courtesy of GENERAL MOTORS CORP.

1. Install the turn signal and multifunction switch assembly (2) onto the steering column tilt head assembly.

NOTE: Refer to **Fastener Notice** in **Cautions and Notices**.

IMPORTANT: Be sure that the electrical contact of the turn signal and multifunction switch assembly (2) rests on the turn signal cancel cam assembly.

2. Screw the 2 pan head tapping screws (1) and (3) into the turn signal and multifunction assembly (2).

Tighten

- Tighten the top pan head tapping screw (1) to 3 N.m (27 lb in).
- Tighten the side pan head tapping screw (3) to 7 N.m (62 lb in).

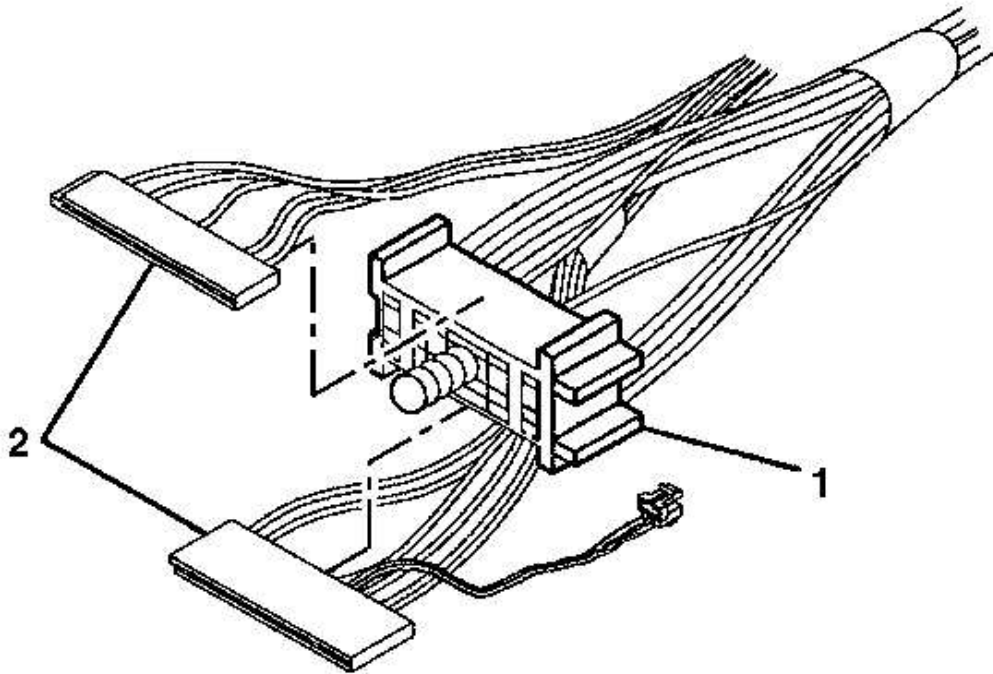

Fig. 32: Turn Signal & Multifunction Switch Assembly Connectors

Courtesy of GENERAL MOTORS CORP.

3. Slide the 2 connectors (2) of the turn signal and multifunction switch assembly into the bulkhead connector (1).

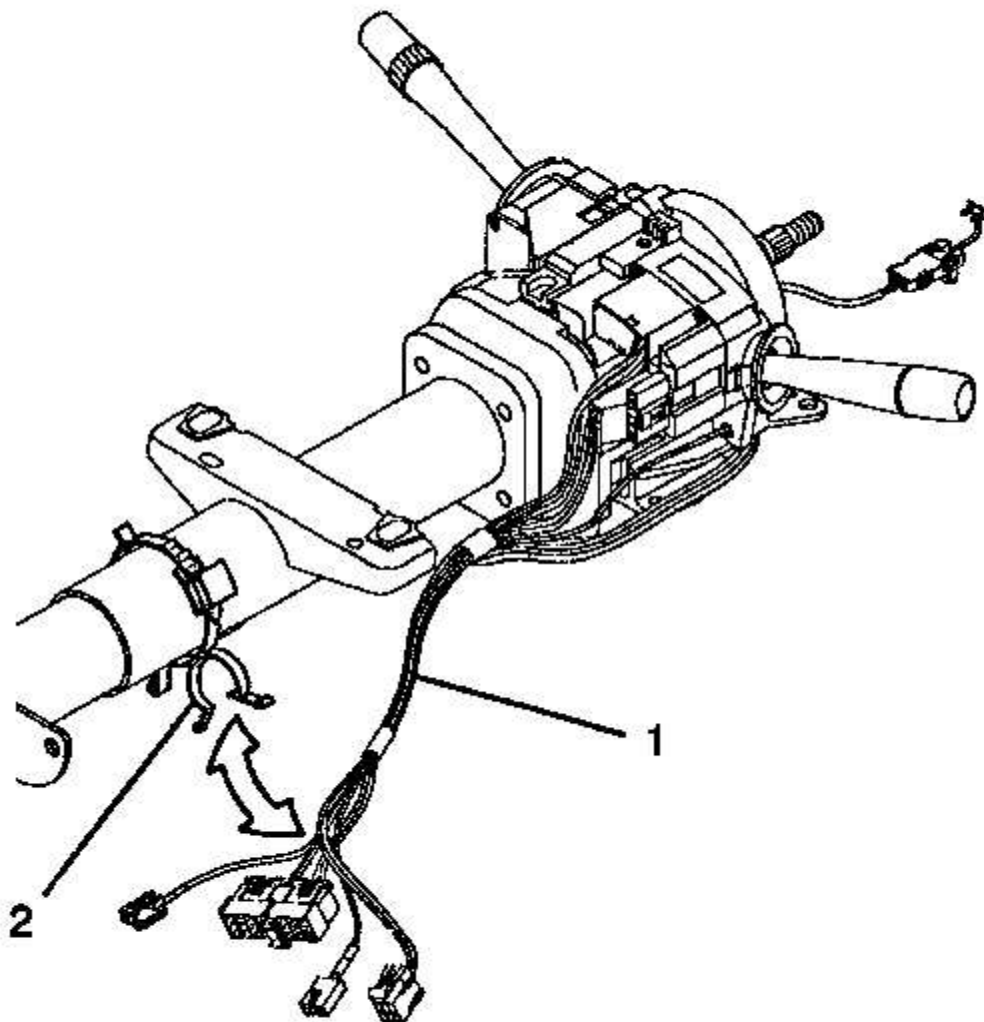

Fig. 33: View Of Steering Column Wire Harness Assembly & Wire Harness Strap
Courtesy of GENERAL MOTORS CORP.

4. Connect the turn signal and multifunction switch assembly connector to the SIR coil connector.

IMPORTANT: The abrasion sleeve must be installed back onto the steering column wire harness assembly. The ignition lock cylinder case wires and connector must be hanging out of the middle of the abrasion sleeve.

5. Install the wire harness assembly (1) into the wire harness strap (2).

2003 Chevrolet Impala LS

2003 STEERING Steering Wheel & Column - Impala & Monte Carlo

6. Install the upper and lower trim covers. Refer to [Steering Column Trim Covers Replacement](#).
7. Enable the SIR system. Refer to [SIR Disabling and Enabling Zone 3](#) in SIR.