

ADJUSTMENTS

ENGINE TORQUE STRUT ADJUSTMENT

NOTE: Whenever a torque strut bolt(s) is loosened, this procedure must be performed. Upper and lower torque struts need to be adjusted together to assure proper engine positioning and engine mount loading.

NOTE: To prevent minimal upward lifting of engine, floor jack must be positioned as shown. See [Fig. 1](#) .

1. Remove pencil strut. See [Fig. 2](#) . Loosen upper and lower torque strut attaching bolt at suspension crossmember and shock tower bracket. Engine position may now be adjusted by positioning a suitable floor jack on the forward edge of transmission bellhousing. See [Fig. 1](#) .
2. With engine supported, remove upper and lower torque struts attachment bolt(s) at shock tower bracket and suspension crossmember. See [Fig. 3](#) . Verify that torque struts are free to move within shock tower bracket and crossmember. Reinstall torque strut bolt(s), but DO NOT tighten.
3. Carefully apply upward force, allowing upper engine to rotate rearward until distance between center of rearmost attaching stud on engine mount bracket (point "A") and center of hole for washer hose clip on shock tower bracket (point "B") is 4.7" (119 mm). See [Fig. 4](#) .

CAUTION: Engine must be held in position with jack until both upper and lower torque strut bolts are tightened.

4. With engine held at proper position, tighten both upper and lower torque strut bolts to specification. See [TORQUE SPECIFICATIONS](#) . Install pencil strut, and tighten nuts to specification. Remove floor jack.

2001 Chrysler PT Cruiser

CHRYSLER 2.4L 4-Cylinder - VINs B & S - 2001-05 - PT Cruiser & SRT-4

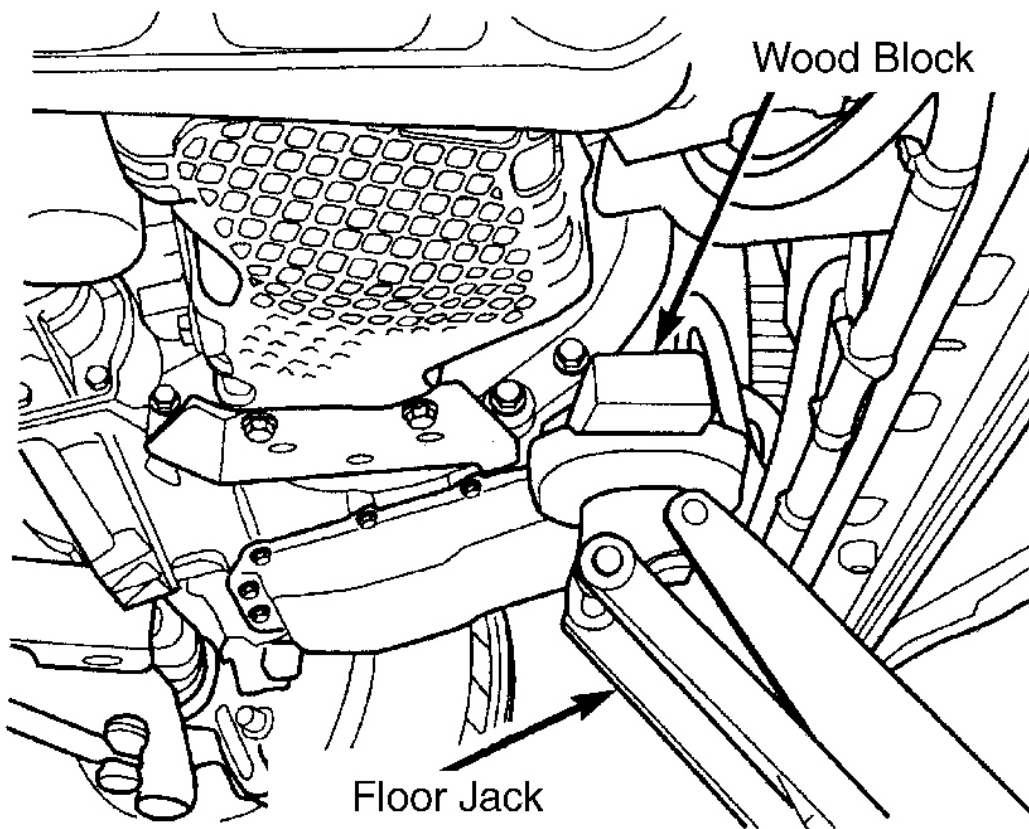

G00256417

Fig. 1: Positioning Floor Jack
Courtesy of CHRYSLER CORP.

2001 Chrysler PT Cruiser

CHRYSLER 2.4L 4-Cylinder - VINs B & S - 2001-05 - PT Cruiser & SRT-4

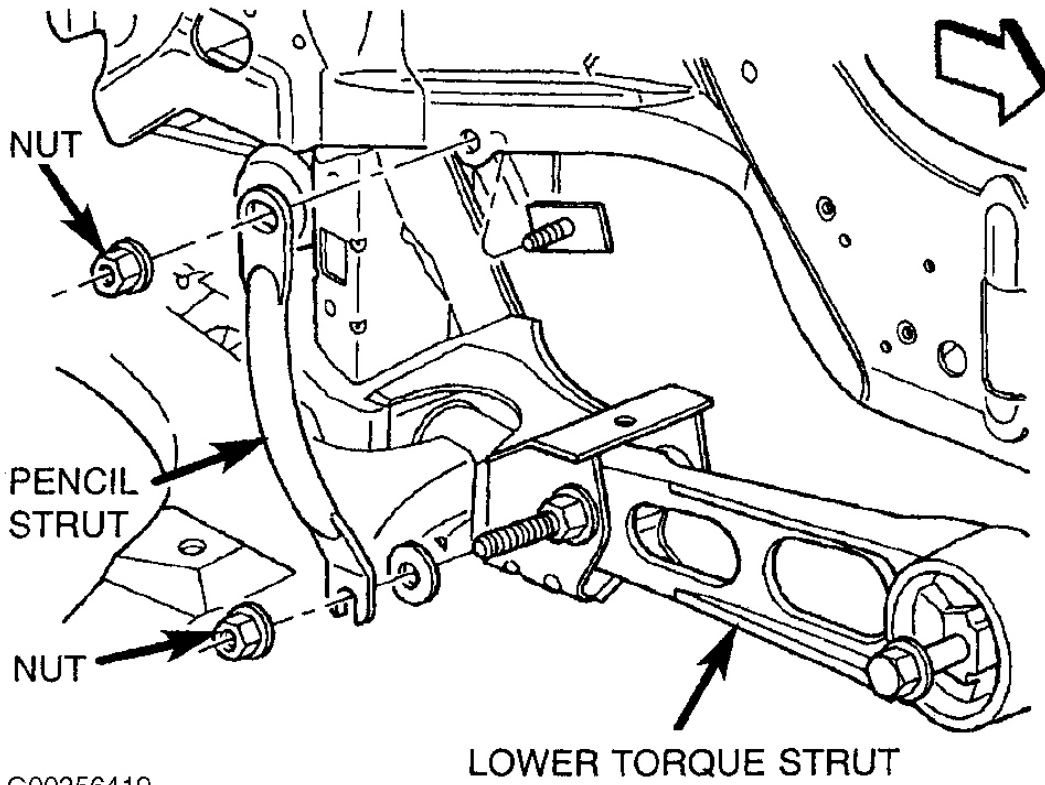

G00256419

Fig. 2: Removing Pencil Strut
Courtesy of CHRYSLER CORP.

2001 Chrysler PT Cruiser

CHRYSLER 2.4L 4-Cylinder - VINs B & S - 2001-05 - PT Cruiser & SRT-4

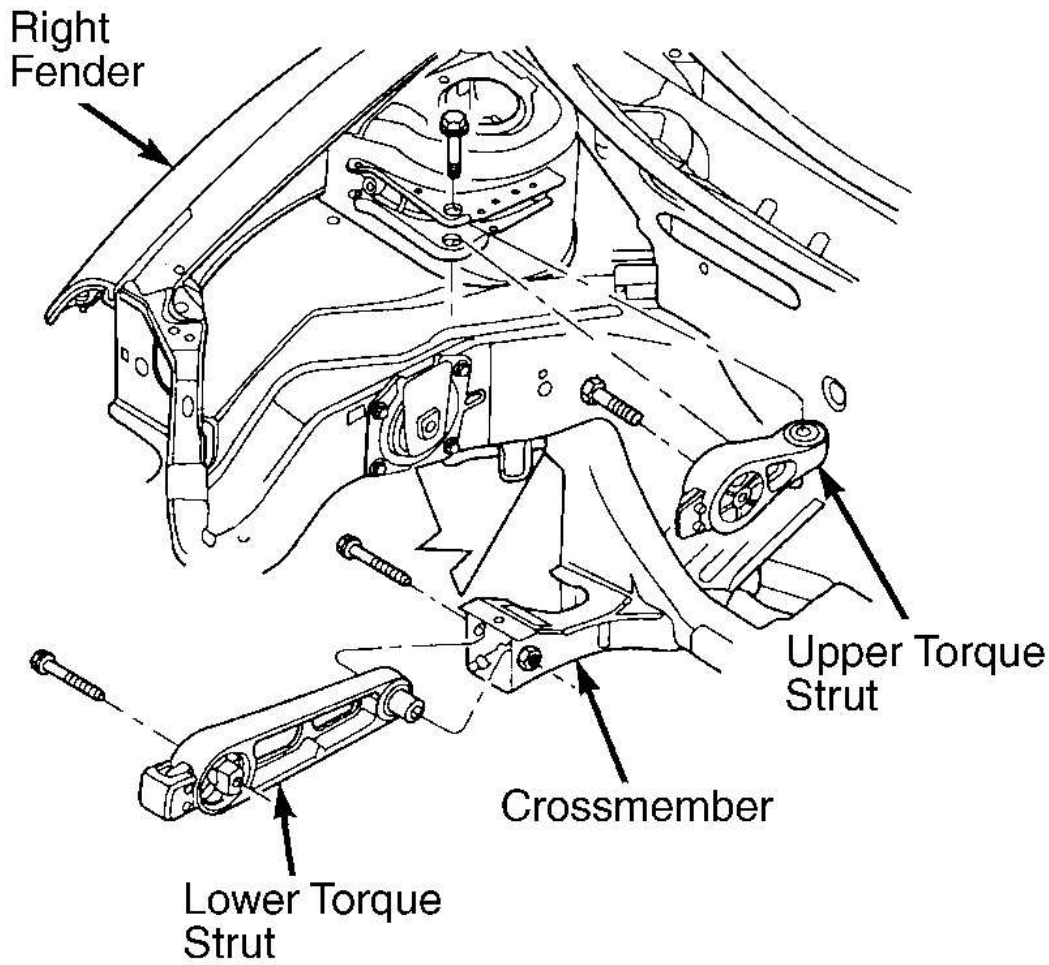

G00256395

Fig. 3: Removing Upper & Lower Engine Torque Struts
Courtesy of CHRYSLER CORP.

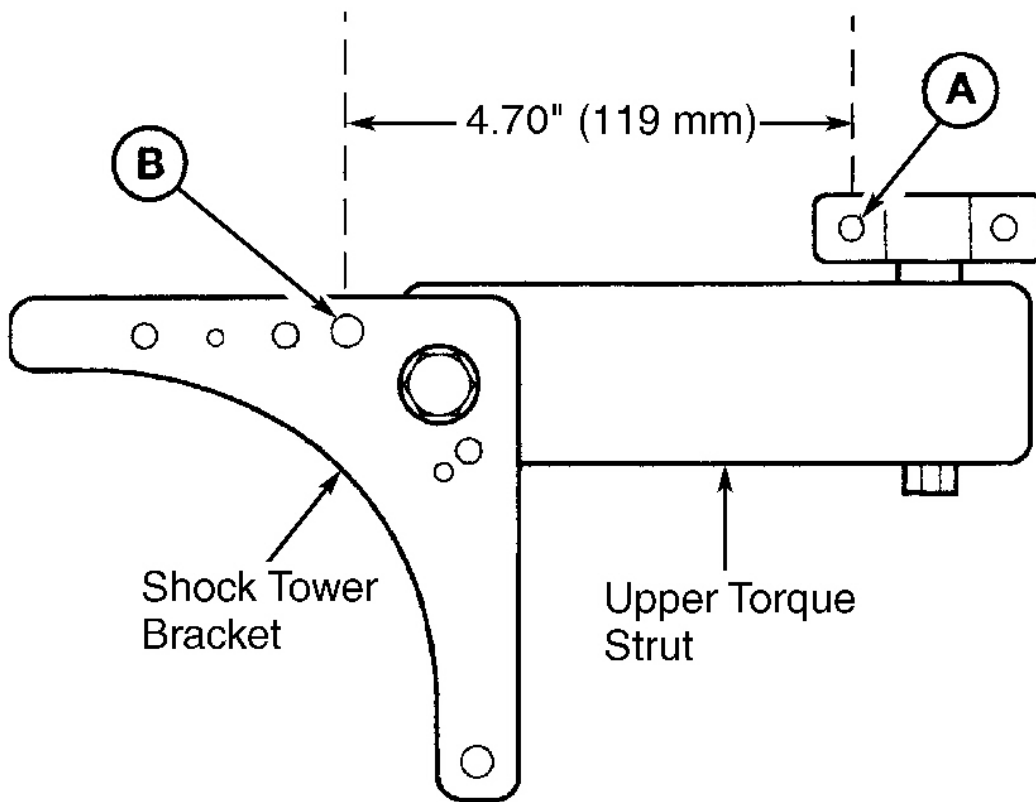

G00256418

Fig. 4: Measuring Engine Position (Top View)

Courtesy of CHRYSLER CORP.