

## 1983 Honda Accord

HONDA' '1.8L 4-Cylinder

### TIMING BELT

#### Removal (1979-83 Accord & 1979-82 Prelude)

1. Disconnect negative battery cable. Remove engine support bolts and nuts. Remove side rubber mount. Remove side mount bracket. Remove cruise control actuator. Remove engine splash guard. Remove water pump drive belt, water pump pulley and crankshaft pulley. See **Fig. 1** . Remove alternator, belt, A/C compressor and belt.

**CAUTION: Crankshaft pulley bolt may stick to the crankshaft threads when properly torqued. A properly torqued pulley bolt may require up to two or three times the installation torque to remove.**

2. Remove valve cover. Ensure cylinder No. 1 is at TDC of compression stroke and camshaft is aligned to mark. See **Fig. 2** . Remove upper timing belt cover from cylinder head. Remove crankshaft pulley. Remove lower timing belt cover from engine block. Loosen, but do not remove, timing belt adjusting and pivot bolts. If reusing belt, mark direction of belt rotation. Slide belt off pulleys.

#### Inspection (1979-83 Accord & 1979-82 Prelude)

Inspect timing belt for wear or rounded edges of drive teeth. Inspect belt for signs of oil contamination. Replace belt if damaged or contaminated. Inspect all drive gears for wear in drive belt area. Replace as necessary.

#### Installation (1979-83 Accord & 1979-82 Prelude)

To install, reverse removal procedure, using care not to excessively bend or twist belt. If reinstalling old belt, install belt so same direction of rotation will be maintained. Adjust drive belts to proper tension.

1983 Honda Accord

HONDA '1.8L 4-Cylinder

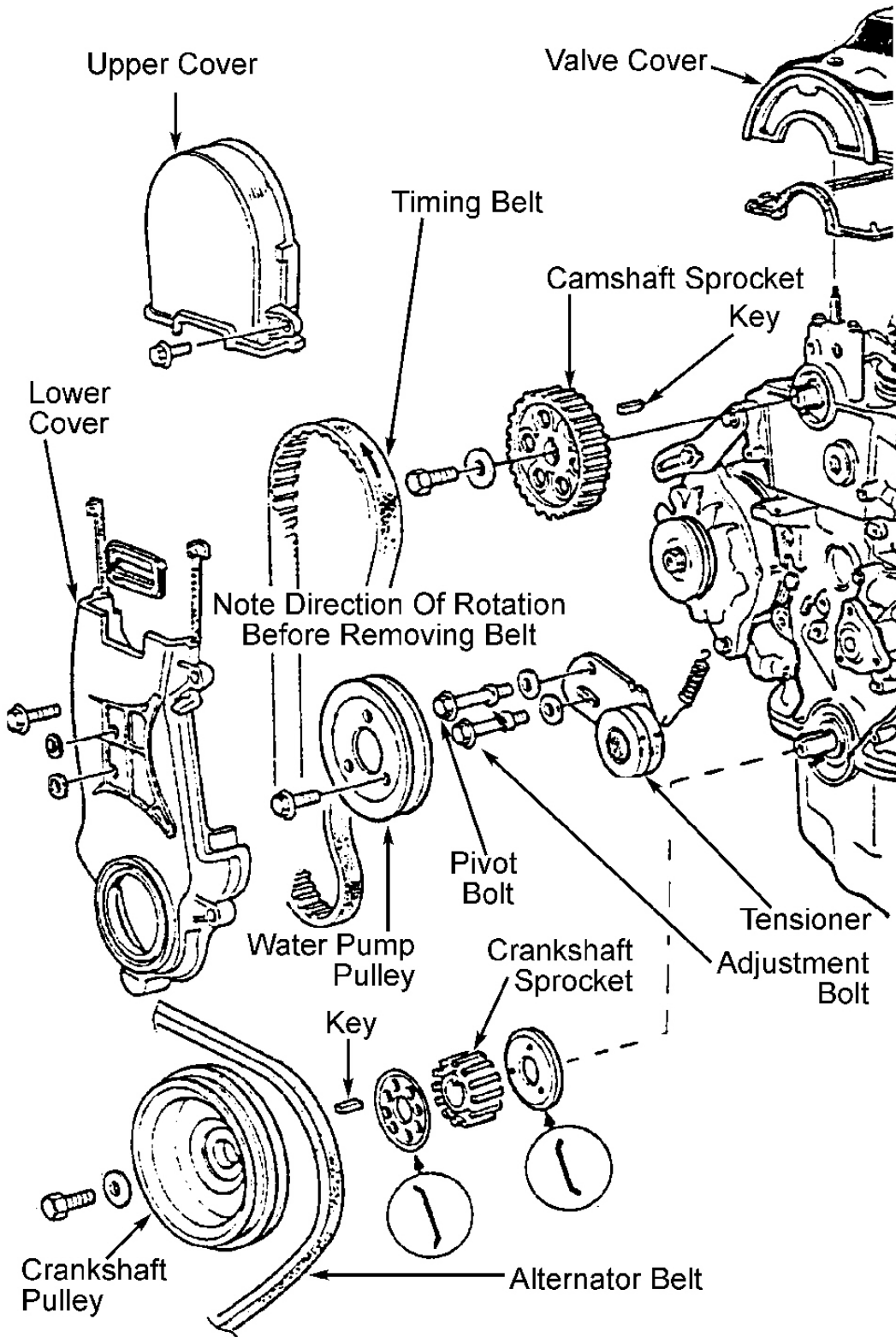

G96C14706

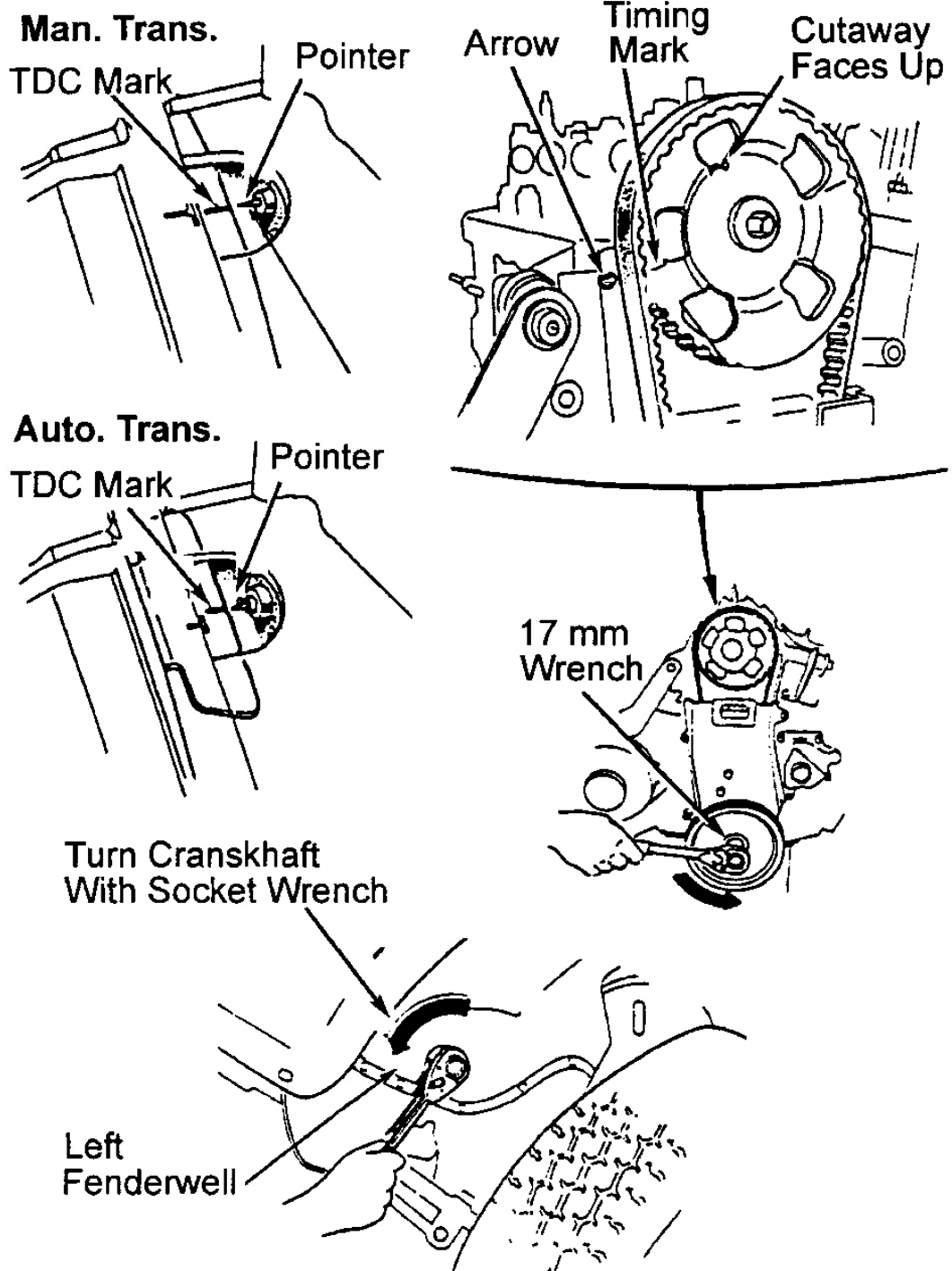
G00214443

**Fig. 2: Aligning Crankshaft & Camshaft Timing Marks (1979-83 Accord & 1979-82 Prelude)**  
Courtesy of AMERICAN HONDA MOTOR CO., INC.

## 1983 Honda Accord

HONDA' '1.8L 4-Cylinder

### Removal (1984-85 Accord & 1983-87 Prelude)

1. Disconnect negative battery cable. Remove engine support bolts and nuts. Remove side rubber mount. Remove side mount bracket. Remove cruise control actuator. Remove engine splash guard. Remove water pump drive belt, water pump pulley. Remove alternator, belt, A/C compressor and belt. Rotate crankshaft counterclockwise to position No. 1 cylinder to TDC of compression stroke. Remove all drive belts.
2. Remove engine valve cover and upper timing belt cover. See **Fig. 1** or **Fig. 3** . Ensure camshaft timing marks are aligned with valve cover surface, and "UP" or "ROUND" mark is upward. See **Fig. 2** , **Fig. 4** or **Fig. 5** .

**CAUTION: Crankshaft pulley bolt may stick to the crankshaft threads when properly torqued. A properly torqued pulley bolt may require up to two or three times the installation torque to remove.**

3. Remove crankshaft pulley. Remove lower timing belt cover from engine block. Loosen timing belt tensioner to relieve timing belt tension.
4. If timing belt is being reused, mark direction of belt rotation before removing. Remove timing belt from camshaft and crankshaft gears.

1983 Honda Accord

HONDA '1.8L 4-Cylinder

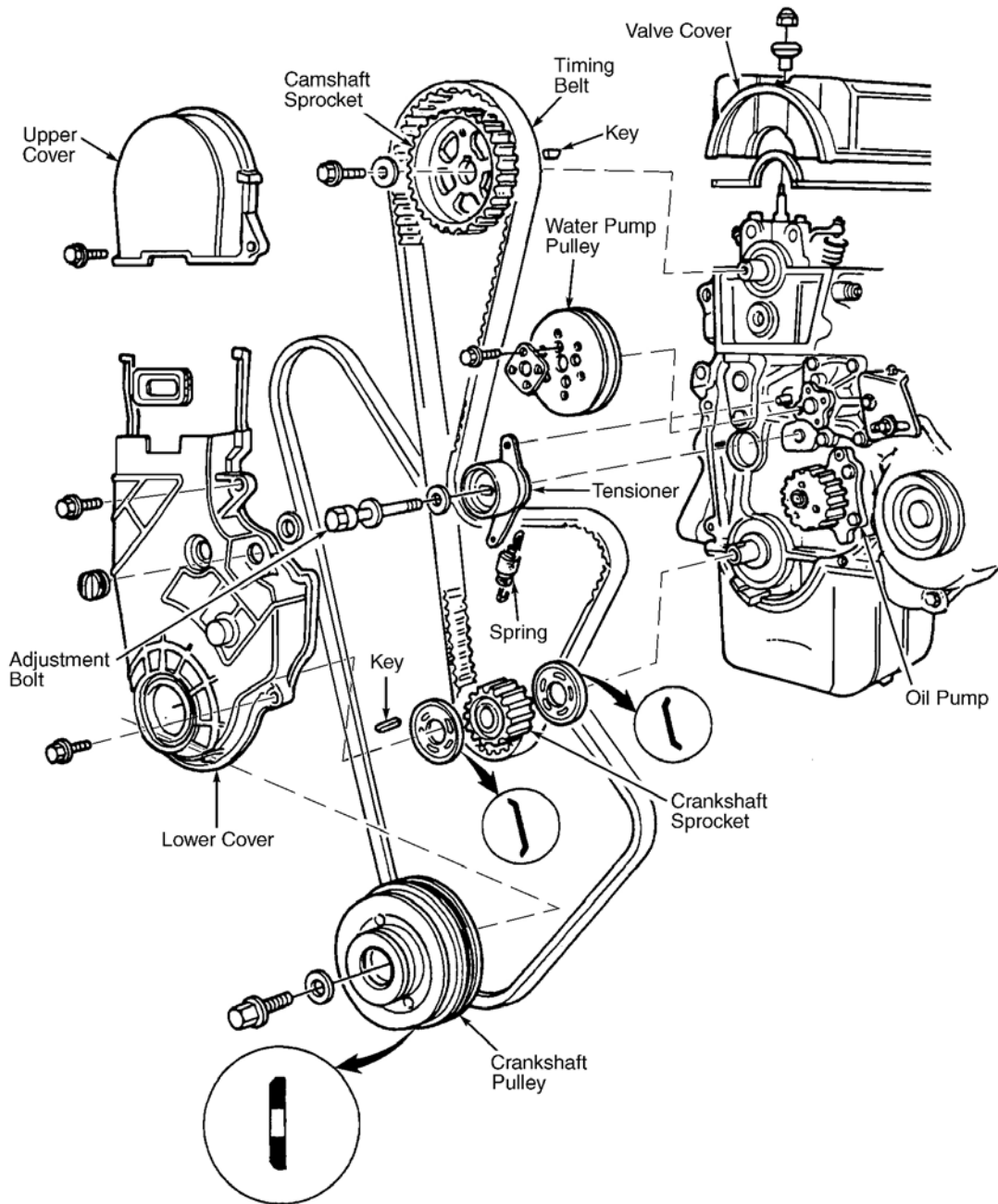

G00019646

**Fig. 3: Exploded View Of Timing Belt & Components (1984-85 Accord & 1983-87 Prelude)**  
Courtesy of AMERICAN HONDA MOTOR CO., INC.

1983 Honda Accord

HONDA '1.8L 4-Cylinder

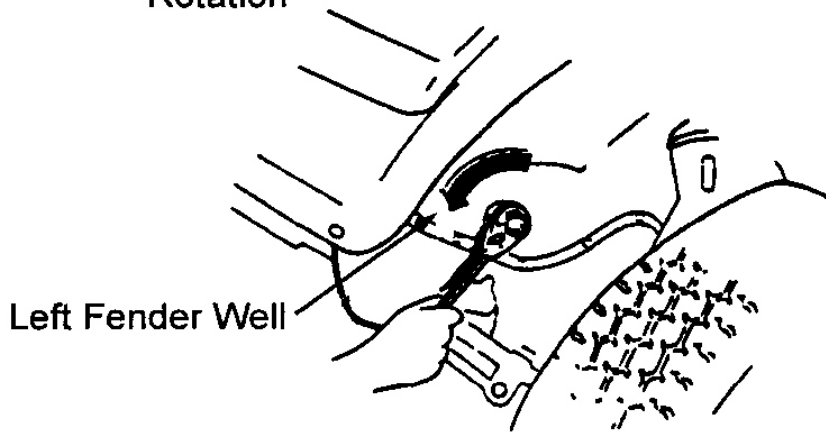
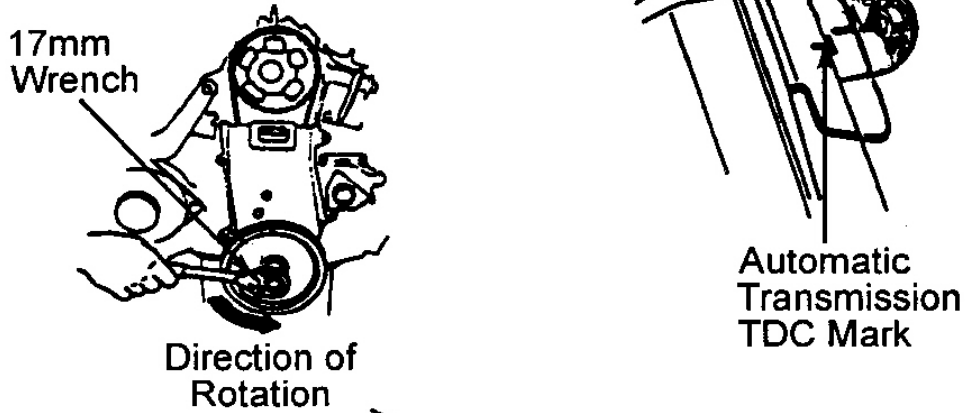
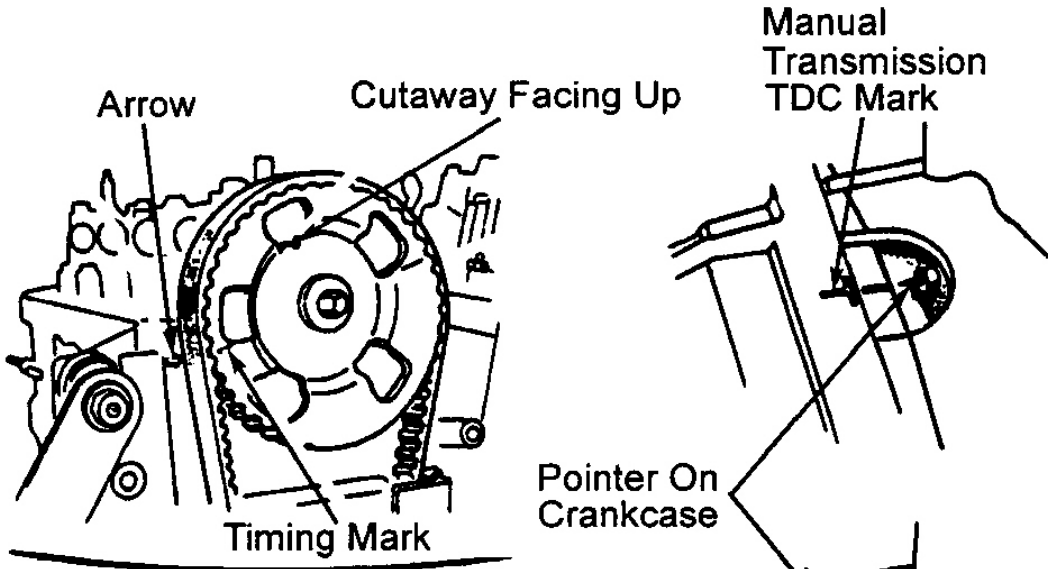

G00214442

1983 Honda Accord

HONDA '1.8L 4-Cylinder

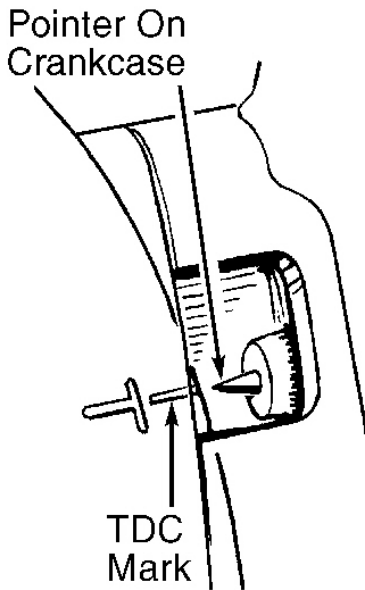
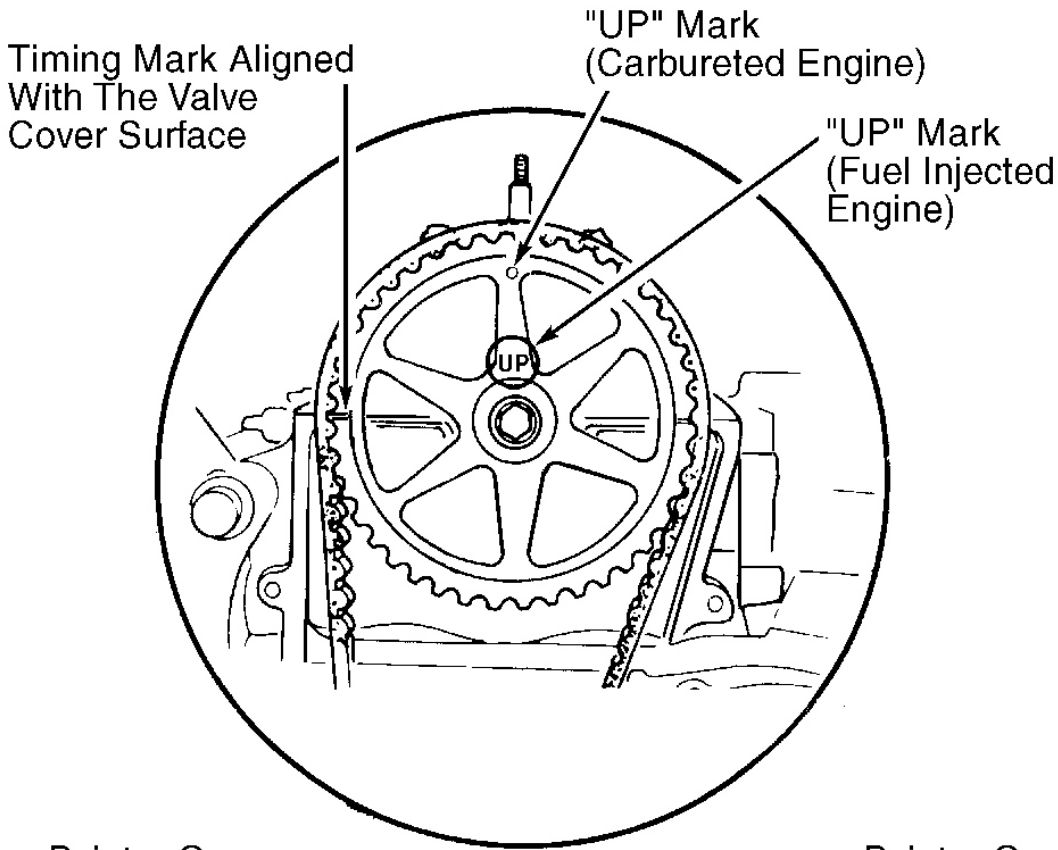

MANUAL TRANSAXLE

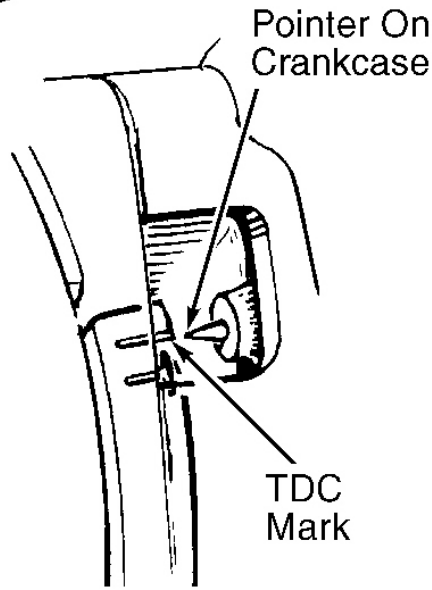

AUTOMATIC TRANSAXLE

97E17149

## 1983 Honda Accord

HONDA' '1.8L 4-Cylinder

**Fig. 5: Aligning Crankshaft & Camshaft Timing Marks (1983-87 Prelude)**  
Courtesy of AMERICAN HONDA MOTOR CO., INC.

### Inspection (1984-85 Accord & 1983-87 Prelude)

Inspect timing belt for wear or rounded edges of drive teeth. Inspect belt for signs of oil contamination. Replace belt if damaged or contaminated. Inspect all drive gears for wear in drive belt area. Replace as necessary.

### Installation (1984-85 Accord & 1983-87 Prelude)

1. Ensure cylinder No. 1 is at TDC of compression stroke. Ensure camshaft timing marks are aligned with valve cover surface, and "UP" or "ROUND" mark is upward. See **Fig. 2** , **Fig. 4** or **Fig. 5** .
2. Install timing belt. Use care not to excessively bend or twist belt. Ensure belt is installed in original direction of rotation. Belt tension must be adjusted. Rotate crankshaft counterclockwise 3 teeth on camshaft pulley to create tension on belt. Tighten tensioner adjustment bolt to specification. See **TORQUE SPECIFICATIONS** .

**CAUTION: Belt tension must be adjusted when engine temperature is cold.**

3. Install washer on crankshaft bolt with flat side toward the pulley. Tighten retaining bolt to specification. See **TORQUE SPECIFICATIONS** . Reverse removal procedure to complete installation. Tighten all bolts to specification. Apply non-hardening sealant to rounded surfaces of front and rear camshaft caps before installing valve cover gasket. Adjust drive belts to proper tension.

## TORQUE SPECIFICATIONS

### TORQUE SPECIFICATIONS

Application	Ft. Lbs. (N.m)
A/C Compressor Bracket Bolt	33 (45)
Alternator Bracket Bolt	33 (45)
Camshaft Sprocket Bolt	
1979-83 Accord & 1980-82 Prelude	22 (23)
1984-85 Accord & 1983-87 Prelude	27 (37)
Crankshaft Pulley Bolt <sup>(1)</sup>	83 (115)
Power Steering Pump Bracket Bolt	33 (45)
Timing Belt Adjuster Bolt	
1979-83 Accord & 1980-82 Prelude <sup>(2)</sup>	22 (23)
1984-85 Accord & 1983-87 Prelude	31 (42)
	<b>INCH Lbs. (N.m)</b>
Timing Belt Cover Bolt	89 (10)
Valve Cover Nut	89 (10)
Water Pump Bolt	108 (12)
