

**KNUCKLE & WHEEL BEARING ASSEMBLY**

**NOTE:** Always discard old bearings and seals. Do not reuse.

**Removal & Installation**

1. Raise and support vehicle. Remove wheel. Using chisel, unstake axle nut and remove. Remove brake caliper assembly from steering knuckle without disconnecting hydraulic line. Wire caliper out of way. Disconnect ABS speed sensor (if equipped).
2. Remove brake rotor. Disconnect ball joint from knuckle. Remove tie rod cotter pin and nut. Using a puller, disconnect tie rod end from steering knuckle. Scribe reference mark on strut-to-knuckle retaining bolts. Remove steering knuckle-to-strut retaining bolt(s).
3. Remove axle shaft from steering knuckle by using Adapter (922493000) and Remover (921122000). See **Fig. 4** . Remove steering knuckle from vehicle.
4. Mount knuckle assembly on Stand (927080000). Mount Hub Remover (927060000) on knuckle assembly, and press out hub. Remove inner seal and snap ring from knuckle. Support knuckle and press out inner bearing.
5. Remove ABS sensor ring from hub (if equipped). Using bearing splitter, remove bearing and seal from hub. Mount knuckle in press and install inner, outer bearings and seals with appropriate adapters. Ensure bearings are properly lubricated. Install snap ring before installing inner seal.
6. Mount ABS sensor ring to hub (if equipped). Press hub in knuckle assembly. Mount knuckle on vehicle. To complete installation, reverse removal procedures. Tighten bolts to specification. See **TORQUE SPECIFICATIONS** .

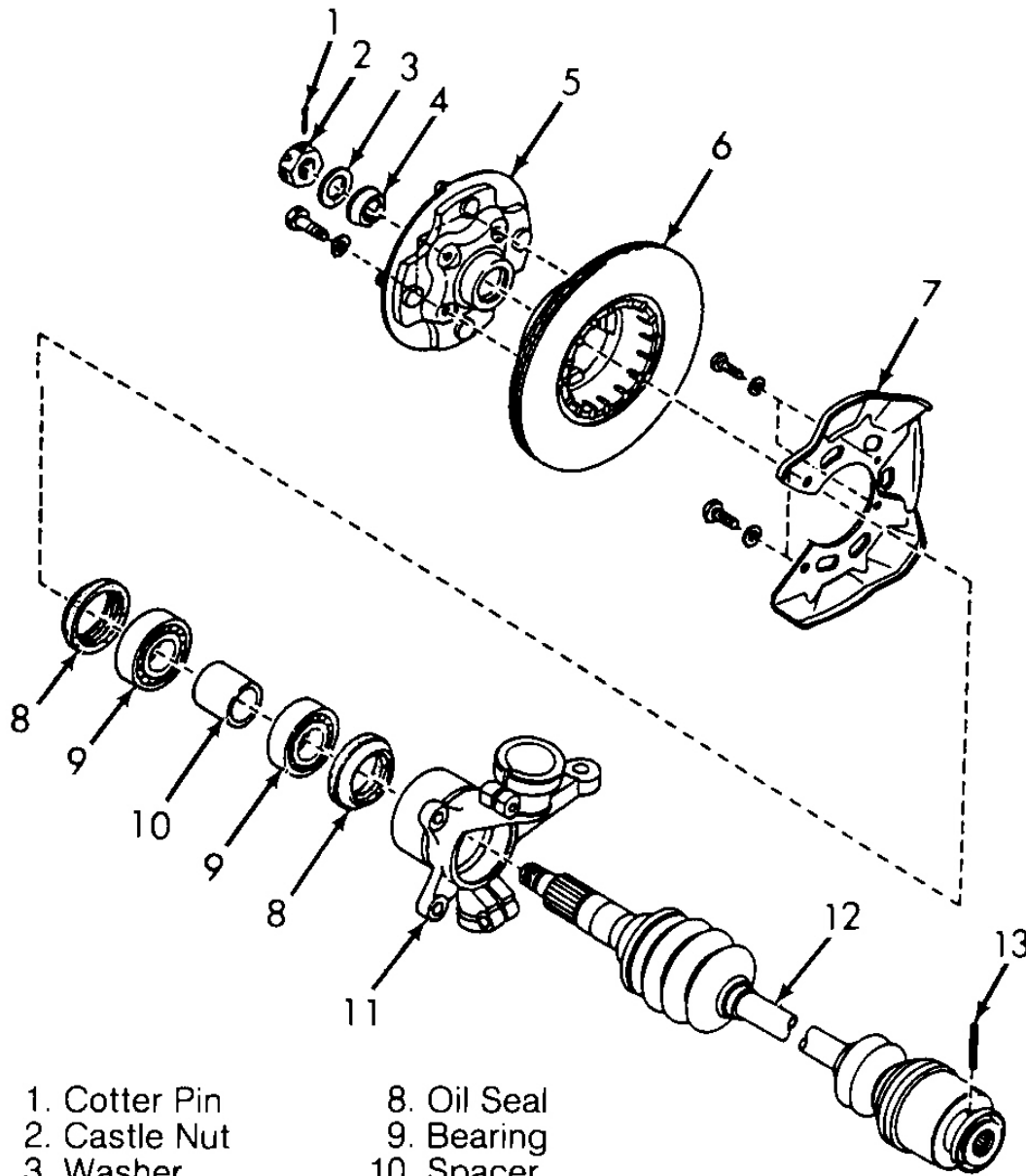

- |                 |                         |
|-----------------|-------------------------|
| 1. Cotter Pin   | 8. Oil Seal             |
| 2. Castle Nut   | 9. Bearing              |
| 3. Washer       | 10. Spacer              |
| 4. Center Piece | 11. Knuckle             |
| 5. Hub          | 12. Axle Shaft Assembly |
| 6. Brake Rotor  | 13. Spring Pin          |
| 7. Disc Cover   |                         |

91F02394

**Fig. 4: Exploded View Of Front Axle Hub (Typical)**  
 Courtesy of SUBARU OF AMERICA, INC.